

Department of Engineering
Tim Bryan, P.E., County Engineer

3137 South Liberty Street, Canton, MS 39046
Office (601) 790-2525 FAX (601) 859-3430

MEMORANDUM

June 22, 2023

To: Sheila Jones, Supervisor, District I
Trey Baxter, Supervisor, District II
Gerald Steen, Supervisor, District III
Karl Banks, Supervisor, District IV
Paul Griffin, Supervisor, District V

From: Tim Bryan, P.E., PTOE
County Engineer

Re: Comcast Cable Utility Permit
County Road Name, Ratliff Ferry Rd, Robinson Rd, Shamrock Drive, and more

The Engineering Department recommends approval of the permit application for Comcast Cable is attaching 24 CT and 48 CT fiber to existing poles, boring and installing 2" HDPE to pull 24 CT fiber within the right-of-way owned by the County including the listed roads below.

- Ratliff Ferry Road
- Robinson Road
- Shamrock Drive
- And Lone Pine Road

Revised: 2/14/2019



PERMIT APPLICATION FOR THE CONSTRUCTION OR ADJUSTMENT OF A UTILITY WITHIN COUNTY ROAD RIGHT-OF-WAY

Utility Information: Utility Name: COMCAST CABLE

Address: 3425 Malone Drive City/State/Zip: Chamblee/ GA/ 30-341

Contact Person: Linda Taibl Contact's Phone: _____

Project Information: County Road Name: Ratliff Ferry Rd, Robinson Rd, Shamrock Dr, Lone Pine Rd

(If located within more than one road right-of-way, use Appendix 1 for additional descriptions)

Beginning Location: 32.627199, -89.901774 Ending Location: 32.60762, -89.880394

Length of Project: 18942FT Section: 34 Township: 3 Range: 69

Description of Work: COMCAST IS ATTACHING 24 CT AND 48CT FIBER TO EXISTING POLES, BORING AND INSTALLING 2" HDPE TO PULL 24CT FIBER WITHIN THE RIGHT-OF-WAY OWNED BY THE COUNTY.

TOTAL INSTALLATION LENGTH IN ROW: 18942FT

Check Box if Appendix 1 is to be included as a part of this Application

Whereas the above stated Utility makes application to the **Madison County Board of Supervisors** for a Construction Permit. Attached hereto are drawings and plans for the construction of the above facilities located within Madison County owned public rights-of-way. Once stamped by the Madison County Engineering Department, these plans shall not be changed or altered without written approval of the County Engineer, or his representative. A copy of the approved permit and plans shall be on-site at all times during construction.

The Applicant Utility shall comply with all policies, procedures and construction practices as outlined in *A Policy for The Accommodation of Utility Facilities within the Right-of-Way of all Public County Roads* (hereinafter referred to as the "Policy"), as adopted on November 1, 2005, by the **Madison County Board of Supervisors**, and which is hereby made a part of this Application Agreement.

If facilities are to be located within the Rights-of-Way of the County-Federal or State Aid System, Applicant Utility also agrees to comply with applicable provisions of *S.O.P. No. SA II-2-8, Accommodation of Utilities on Rights-of-Way*, issued by the State Aid Engineer and dated July 1, 2005.

The Applicant Utility understands and agrees that, except as herein granted, no right, title, claim, or easement to said road right-of-way is granted by the issuance of this permit. If this Utility is listed in the general provisions of the Policy, it will be adjusted to comply with same without cost to the County, unless the variance from the Policy has been approved by the granting of the Permit pursuant to this Application.

The Applicant Utility further understands that the Utility's engineering, plant, or other personnel will be responsible for the staking and construction supervision of the work set out above and as shown on the attached plans. If work impacts traffic in any way, the appropriate traffic control shall be installed per the *Manual of Uniform Traffic Control Devices*, Latest Edition.

The Applicant Utility understands that the County Engineer, or his representative, may issue a Stop Work Order at any time if it is deemed that site conditions are not suitable for construction or if any of the requirements of this permit are not being met.

Many County Roads have variable Rights-of-Way and/or no Right-of-Way at all and are maintained under a Prescriptive Easement. It is the sole responsibility of the Applicant Utility to verify the existence and limits of public rights-of-way. If none exists, it is the

responsibility of the Applicant Utility to acquire an easement for their Facilities from the applicable property owner(s). Madison County in no way verifies the limits of Right-of-Way as shown on the permit application.

The Applicant Utility shall be responsible for all future maintenance and repair of the facilities installed under this permit. The Applicant Utility shall make future adjustments to, or relocate, the facilities located within road or highway right-of-way when required for road or highway widening or other road or highway construction at no cost to Madison County. The Applicant Utility shall relocate said utilities within sixty (60) days of notification by County by registered mail, return receipt requested, unless otherwise designated by the County Engineer. Further, any maintenance, repair, or construction shall be done in such a manner as to occasion no unreasonable interference with the normal flow and safety to traffic and at the expense of the utility company. When reasonable care has been taken to locate said utility facilities within the right-of-way, the Applicant Utility understands that any damages caused by routine maintenance and construction by County forces shall be borne by the Applicant Utility.

The Applicant Utility further agrees to indemnify and hold Madison County harmless for any and all claims, accidents, damages, liabilities and expenses occasioned wholly, or in part, by any act or omission of applicant, its agents or employees. In case County shall, without fault on its own part, be made a party to any litigation commenced by or against applicant, then applicant shall protect and hold County harmless, and shall pay all costs, expenses and reasonable attorney's fees incurred or paid by County in connection with said litigation.

All underground facilities shall be installed at a depth equal to or greater than 48" below the lowest adjacent grade.

All pipes carrying liquid shall be encased under County maintained roads.

WITNESS the signature of the Applicant this the 19 day of 06, 2023.

By: Linda Taibl
(Applicant Signature)

Title: Construction specialist

Note: Applicant must be an employee of the Utility named in this application. The Madison County Board of Supervisors will not recognize a Contractor, Subcontractor, Agent, or Consulting Engineer as the Applicant. Utility Company shall be fully responsible for all work performed under this application.

I, or my authorized representative, have reviewed this application and determined that the drawing, sketches, and plans submitted by the Applicant meet the requirements of A Policy for The Accommodation of Utility Facilities within the Right-of-Way of all Public County Roads.

APPROVED
By **timothy.bryan at 12:40 pm, Jun 27, 2023**

Tim Bryan, P.E.
County Engineer **BJ**

AGREED TO AND APPROVED BY:

Madison County Board President

Date: _____

ENTERED INTO THE MINUTES OF THE BOARD OF SUPERVISORS OF MADISON COUNTY, MISSISSIPPI ON THIS _____ DAY OF _____, 20____.

Appendix 1

County Road Name: Ratliff Ferry Rd
Beginning Location: 32.627199, -89.901774 Ending Location: 32.60762, -89.880394
Length of Project: 11212FT Section: 34 Township: 3 Range: 69
Description of Work: ATTACH NEW 24CT AND 48CT FIBER TO EXISTING POLES, BORE AND INSTALL 2" HDPE TO PULL NEW 24CT FIBER WITHIN THE RATLIFF FERRY RD RIGHT-OF WAY.

County Road Name: Robinson Rd
Beginning Location: 32.618625, -89.914526 Ending Location: 32.620588, -89.901680
Length of Project: 4163FT Section: 34 Township: 3 Range: 69
Description of Work: ATTACH NEW 24CT FIBER TO EXISTING POLES, BORE AND INSTALL 2" HDPE TO PULL NEW 24CT FIBER WITHIN THE ROBINSON RD RIGHT-OF WAY.

County Road Name: Shamrock Dr
Beginning Location: 32.618625, -89.914526 Ending Location: 32.617111, -89.914461
Length of Project: 569FT Section: 34 Township: 3 Range: 69
Description of Work: ATTACH NEW 24CT FIBER TO EXISTING POLES WITHIN THE SHAMROCK DR RIGHT-OF WAY.

County Road Name: Lone Pine Rd
Beginning Location: 32.610408, -89.901381 Ending Location: 32.599375, -89.901965
Length of Project: 2998FT Section: 34 Township: 3 Range: 69
Description of Work: ATTACH NEW 24CT FIBER TO EXISTING POLES WITHIN THE LONE PINE RD RIGHT-OF WAY.

County Road Name: _____
Beginning Location: _____ Ending Location: _____
Length of Project: _____ Section: _____ Township: _____ Range: _____
Description of Work: _____

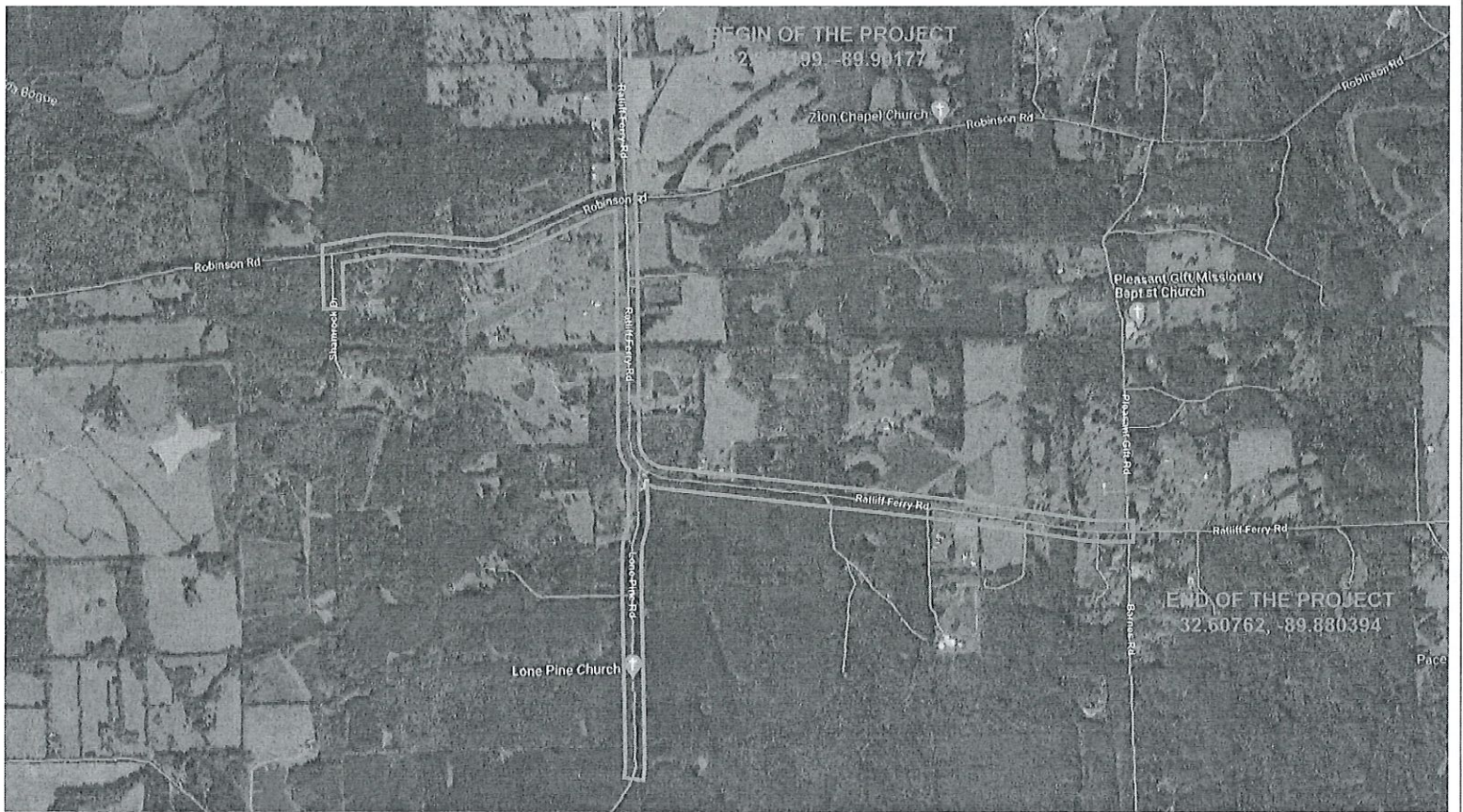

PREPARED BY:

COMCAST IS ATTACHING FIBER TO EXISTING
 POLES, BORING AND INSTALLING NEW CONDUIT WITHIN
 THE RIGHT-OF-WAY OWNED BY THE COUNTY.
 TOTOAL: 18945ft



QUASAR, INC.

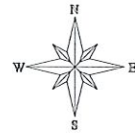

ENGINEERED FOR:



NO SCALE

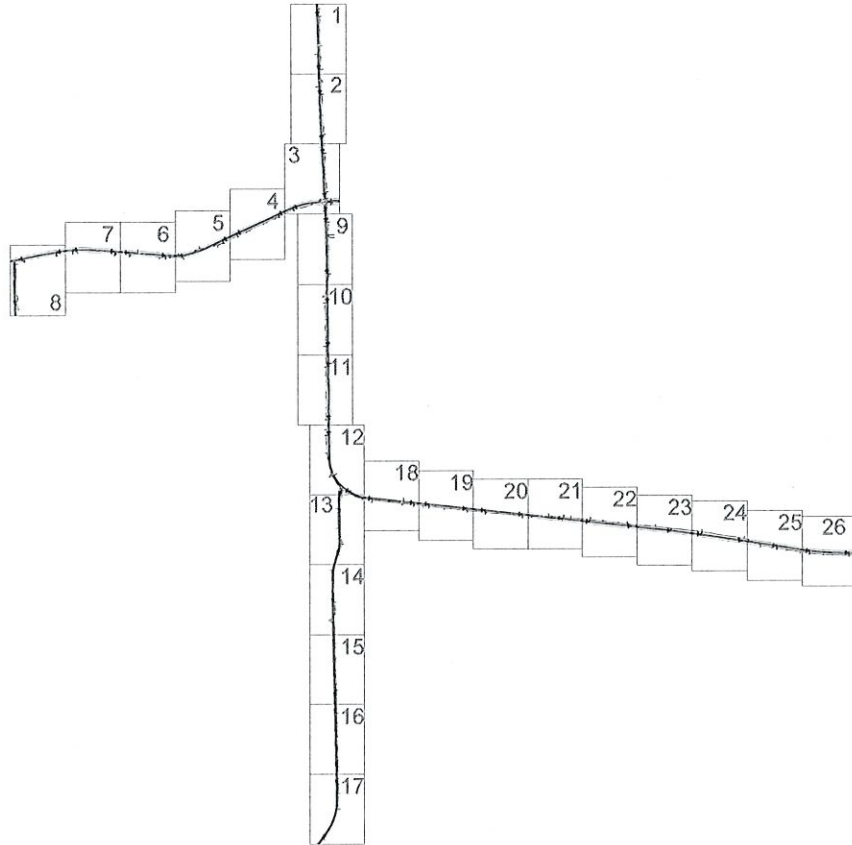

PREPARED BY:



QUASAR, INC.

COMCAST IS ATTACHING FIBER TO EXISTING
 POLES, BORING AND INSTALLING NEW CONDUIT WITHIN
 THE RIGHT-OF-WAY OWNED BY THE COUNTY.
 TOTOAL: 18945ft

NO SCALE

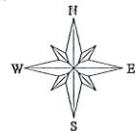

ENGINEERED FOR:



NO MATCH SHEET

PROPOSED COMCAST NEW ATTACHMENT
 18' MINIMUM HEIGHT AT ALL POINTS
 1 48CT FIBER CABLE
 1 24CT FIBER CABLE
 PROPOSED COMCAST UNDERGROUND
 DIRECTIONAL BORE
 4' MINIMUM DEPTH AT ALL POINTS
 1 24CT FIBER CABLE
 NO OTHER BURIED UTILITIES EXIST
 INSTALLATION LENGTH IN RW ON THIS SHEET 1100 FT

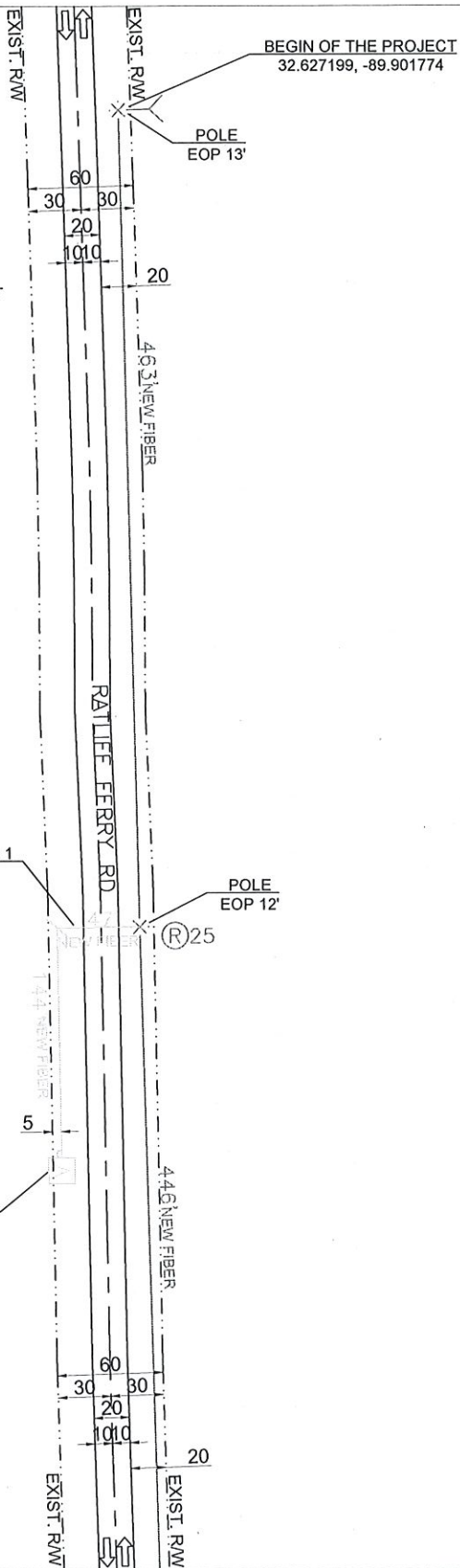

NO MATCH SHEET

NO MATCH SHEET

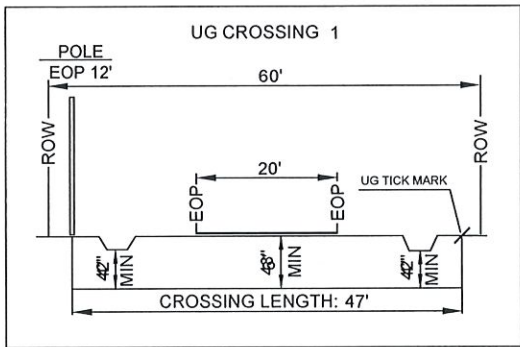

MATCH SHEET 2

PREPARED BY: 	EXISTING POLE PROPOSED PEDESTAL PROPOSED VAULT WATER VALVE FIBER MARKER GAS MARKER MANHOLE SEWER MANHOLE STORM DRAIN	RIGHT OF WAY LINE IRRIGATION LINE WATER LANE GAS LANE PROPOSED ANCHOR PROPOSED RISER	PROPOSED COAXIAL CABLE PROPOSED FIBER CABLE PROPOSED DIRECTIONAL BORE EXISTING CABLE COUNTY LINE		ENGINEERED FOR: 	MADISON COUNTY RATLIFF FERRY RD TRANSPORT FIBER
	LEGEND: RW - RIGHT OF WAY EOP - EDGE OF PAVEMENT DW - DRIVEWAY ROW - PAVED DRIVEWAY	NOTES: BORE HOLE TO BE FILLED SAME DAY VAULT/HOLE TO BE FILLED SAME DAY ALL HOLE TO BE TAMPED AND SODDED	NO SCALE SHEET 1 OF 28			

MATCH SHEET 1

PROPOSED COMCAST NEW ATTACHMENT
 18' MINIMUM HEIGHT AT ALL POINTS
 1 48CT FIBER CABLE
 1 24CT FIBER CABLE
 PROPOSED COMCAST UNDERGROUND
 DIRECTIONAL BORE
 4' MINIMUM DEPTH AT ALL POINTS
 1 24CT FIBER CABLE
 NO OTHER BURIED UTILITIES EXIST
 INSTALLATION LENGTH IN RW ON THIS SHEET 972 FT

PROPOSED VAULT PED

CROSSING 2

POLE
EOP 14'

(R)25

POLE
EOP 20'

578' NEW FIBER

4.4' NEW FIBER

RATLIFF FERRY RD

NO MATCH SHEET

NO MATCH SHEET

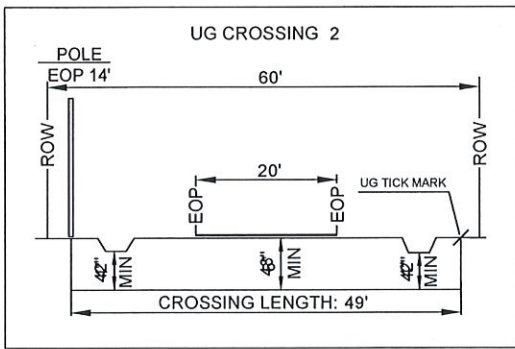

MATCH SHEET 3

PREPARED BY: 	EXISTING POLE PROPOSED PEDESTAL PROPOSED VAULT WATER VALVE FIBER MARKER GAS MARKER MANHOLE SEWER MANHOLE STORM DRAIN	RIGHT OF WAY LINE IRRIGATION LINE WATER LAINE GAS LAINE PROPOSED ANCHOR PROPOSED RISER	PROPOSED COAXIAL CABLE PROPOSED FIBER CABLE PROPOSED DIRECTIONAL BORE EXISTING CABLE COUNTY LINE		ENGINEERED FOR: 	MADISON COUNTY RATLIFF FERRY RD TRANSPORT FIBER
	LEGEND: RW - RIGHT OF WAY EOP - EDGE OF PAVEMENT DW - DRIVEWAY ROW - PAVED DRIVEWAY	NOTES: BORE HOLE TO BE FILLED SAME DAY VAULT HOLE TO BE FILLED SAME DAY ALL HOLE TO BE TAMPED AND SODDED	NO SCALE SHEET 2 OF 28			

MATCH SHEET 2

PROPOSED COMCAST NEW ATTACHMENT
 18' MINIMUM HEIGHT AT ALL POINTS
 1 48CT FIBER CABLE
 1 24CT FIBER CABLE
 INSTALLATION LENGTH IN RW ON THIS SHEET 1134 FT

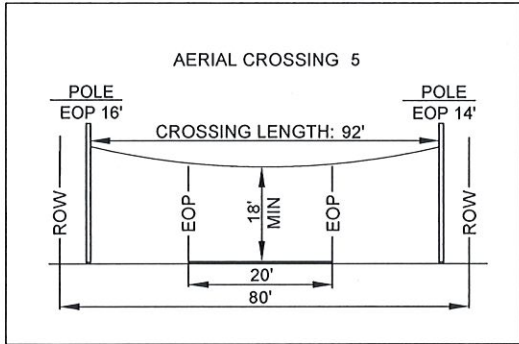
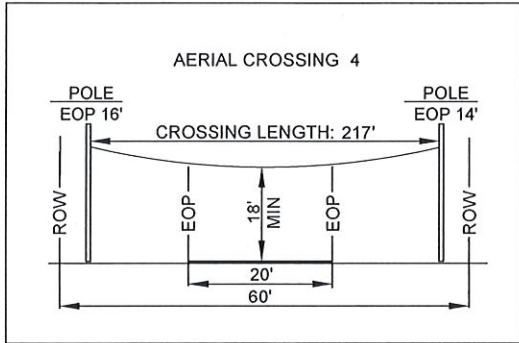
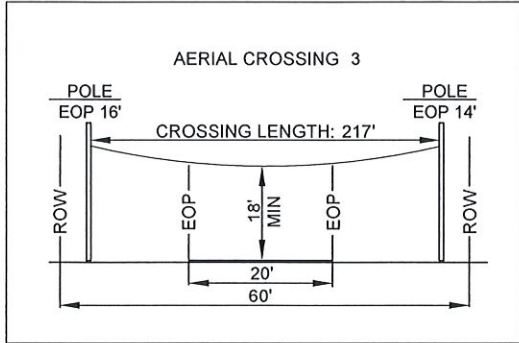

MATCH SHEET 4

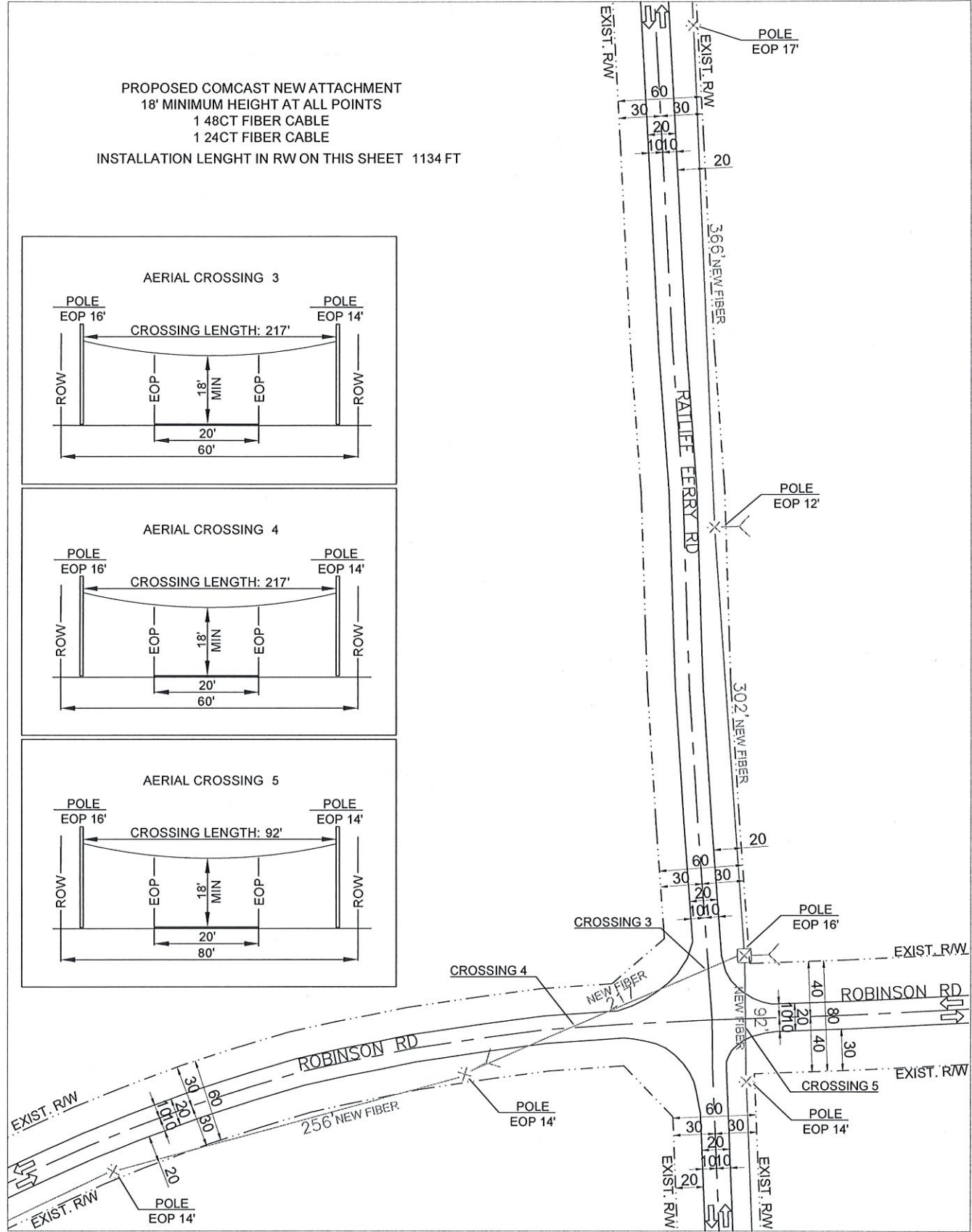

NO MATCH SHEET

MATCH SHEET 9

PREPARED BY: 	EXISTING POLE PROPOSED PEDESTAL PROPOSED VAULT WATER VALVE FIBER MARKER GAS MARKER MANHOLE SEWER MAIN/HOLE STORM DRAIN	RIGHT OF WAY LINE IRRIGATION LINE WATER LAINE GAS LAINE PROPOSED ANCHOR PROPOSED RISER	PROPOSED COAXIAL CABLE PROPOSED FIBER CABLE PROPOSED DIRECTIONAL BORE EXISTING CABLE COUNTY LINE	ENGINEERED FOR: MADISON COUNTY RATLIFF FERRY RD, ROBINSON RD TRANSPORT FIBER 	NO SCALE SHEET 3 OF 26
	LEGEND: RW - RIGHT OF WAY EOP - EDGE OF PAVEMENT DW - DRIVEWAY PAV - PAVED DRIVEWAY	NOTES: BORE HOLE TO BE FILLED SAME DAY VAULT HOLE TO BE FILLED SAME DAY ALL HOLE TO BE TAMPED AND SOCCED			

NO MATCH SHEET

PROPOSED COMCAST NEW ATTACHMENT
 18' MINIMUM HEIGHT AT ALL POINTS
 1 24CT FIBER CABLE
 INSTALLATION LENGTH IN RW ON THIS SHEET 777 FT

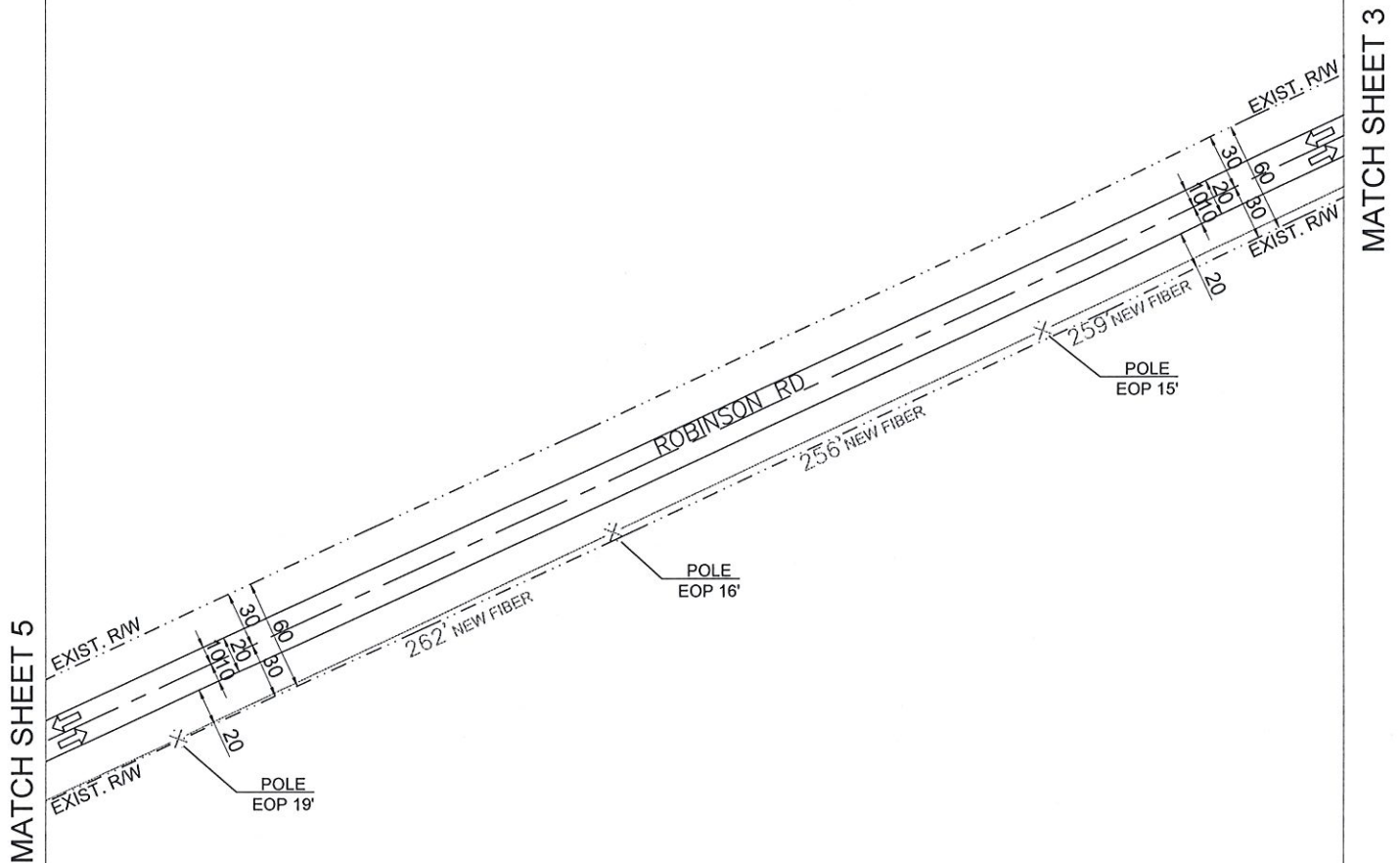

NO MATCH SHEET

PREPARED BY: 	EXISTING POLE PROPOSED PEDESTAL PROPOSED VAULT WATER VALVE FIBER MARKER GAS MARKER MANHOLE SEWER MANHOLE STORM DRAIN	RIGHT OF WAY LINE IRRIGATION LINE WATER LINE GAS LAINE PROPOSED ANCHOR PROPOSED RISER	PROPOSED COAXIAL CABLE PROPOSED FIBER CABLE PROPOSED DIRECTIONAL BORE EXISTING CABLE COUNTY LINE		ENGINEERED FOR: 	MADISON COUNTY ROBINSON RD TRANSPORT FIBER
	LEGEND: RW - RIGHT OF WAY EOP - EDGE OF PAVEMENT DW - DRIVEWAY PDW - PAVED DRIVEWAY	NOTES: BORE HOLE TO BE FILLED SAME DAY VAULT HOLE TO BE FILLED SAME DAY ALL HOLE TO BE TAMPED AND SOODED	NO SCALE SHEET 4 OF 26			

NO MATCH SHEET

PROPOSED COMCAST NEW ATTACHMENT
 18' MINIMUM HEIGHT AT ALL POINTS
 1 24CT FIBER CABLE
 INSTALLATION LENGTH IN RW ON THIS SHEET 722 FT

MATCH SHEET 6

MATCH SHEET 4

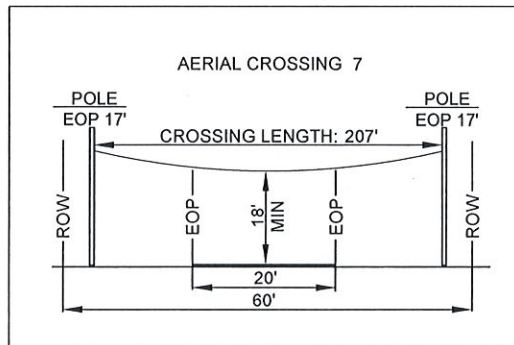
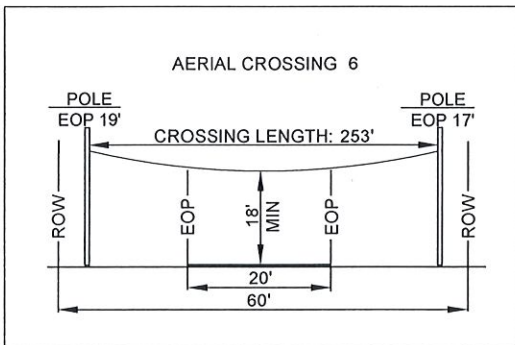
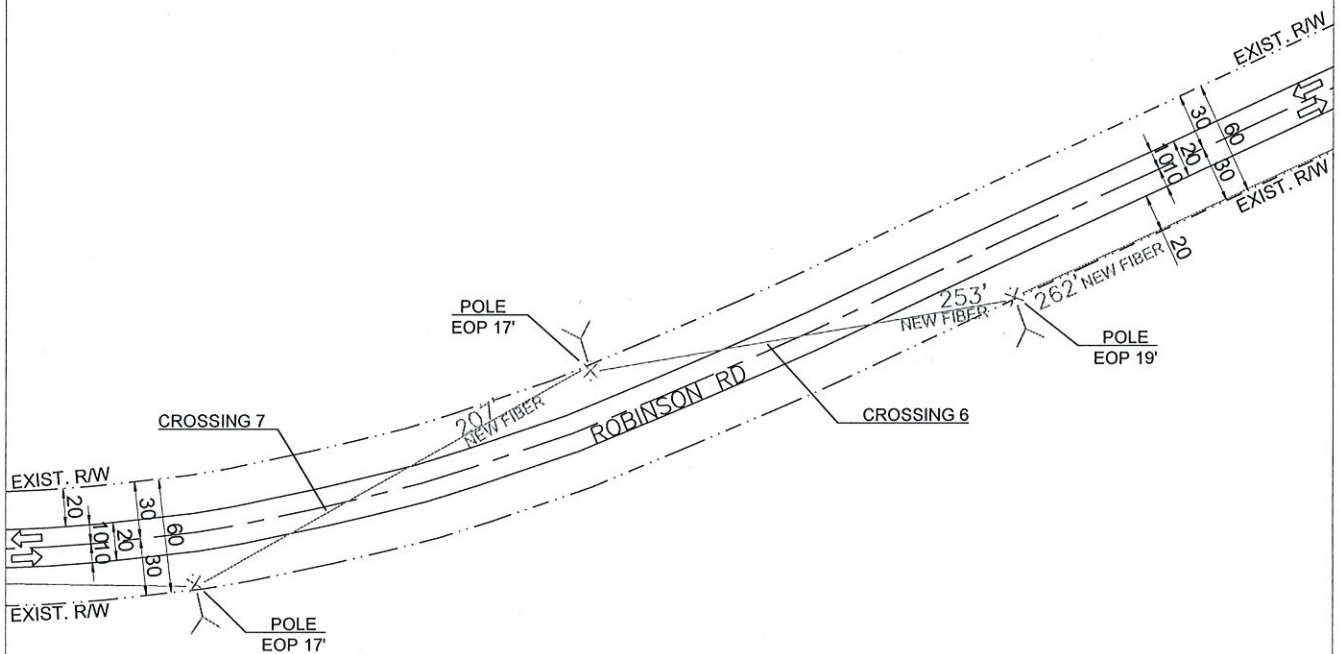

NO MATCH SHEET

PREPARED BY: 	EXISTING POLE PROPOSED PEDESTAL PROPOSED VAULT WATER VALVE FIBER MARKER GAS MARKER MANHOLE SEWER MANHOLE STORM DRAIN	RIGHT OF WAY LINE IRRIGATION LINE WATER LANE GAS LANE PROPOSED ANCHOR PROPOSED RISER	PROPOSED COAXIAL CABLE PROPOSED FIBER CABLE PROPOSED DIRECTIONAL BORE EXISTING CABLE COUNTY LINE		ENGINEERED FOR: MADISON COUNTY ROBINSON RD TRANSPORT FIBER
	LEGEND: RW - RIGHT OF WAY EOP - EDGE OF PAVEMENT DW - DRIVEWAY PDW - PAVED DRIVEWAY	NOTES: BORE HOLE TO BE FILLED SAME DAY VAULT HOLE TO BE FILLED SAME DAY ALL HOLE TO BE TAMPED AND SOCCED			NO SCALE SHEET 5 OF 28

NO MATCH SHEET

PROPOSED COMCAST NEW ATTACHMENT
 18' MINIMUM HEIGHT AT ALL POINTS
 1 24CT FIBER CABLE
 PROPOSED COMCAST UNDERGROUND
 DIRECTIONAL BORE
 4' MINIMUM DEPTH AT ALL POINTS
 1 24CT FIBER CABLE
 NO OTHER BURIED UTILITIES EXIST
 INSTALLATION LENGTH IN RW ON THIS SHEET 907 FT

MATCH SHEET 7

MATCH SHEET 5

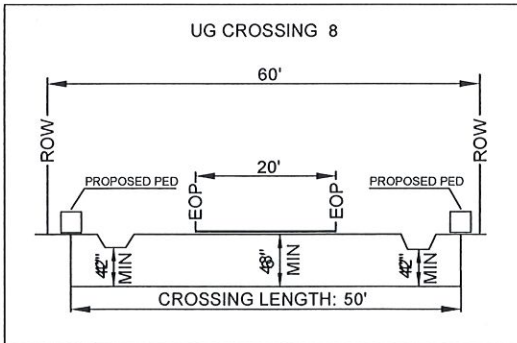
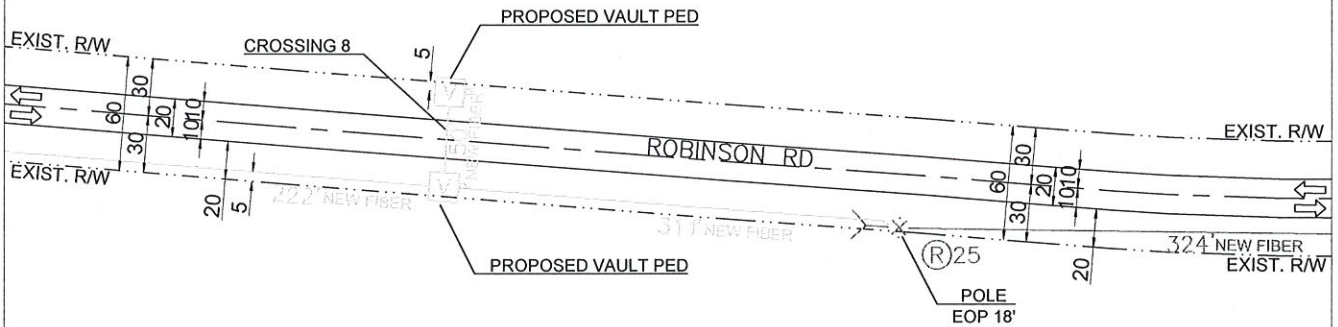

NO MATCH SHEET

PREPARED BY: 	EXISTING POLE PROPOSED PEDESTAL PROPOSED VAULT WATER VALVE FIBER MARKER GAS MARKER MANHOLE SEWER MANHOLE STORM DRAIN	RIGHT OF WAY LINE IRRIGATION LINE WATER LANE GAS LANE PROPOSED ANCHOR PROPOSED RISER	PROPOSED COAXIAL CABLE PROPOSED FIBER CABLE PROPOSED DIRECTIONAL BORE EXISTING CABLE COUNTY LINE		ENGINEERED FOR: MADISON COUNTY ROBINSON RD TRANSPORT FIBER		NO SCALE	SHEET 6 OF 28
	LEGEND: RW - RIGHT OF WAY EOP - EDGE OF PAVEMENT DW - DRIVEWAY POW - PAVED DRIVEWAY	NOTES: BORE HOLE TO BE FILLED SAME DAY VAULT HOLE TO BE FILLED SAME DAY ALL HOLE TO BE TAMPED AND SODDED						

NO MATCH SHEET

PROPOSED COMCAST UNDERGROUND
 DIRECTIONAL BORE
 4' MINIMUM DEPTH AT ALL POINTS
 1 24CT FIBER CABLE
 NO OTHER BURIED UTILITIES EXIST
 INSTALLATION LENGTH IN RW ON THIS SHEET 674 FT

MATCH SHEET 8

MATCH SHEET 6

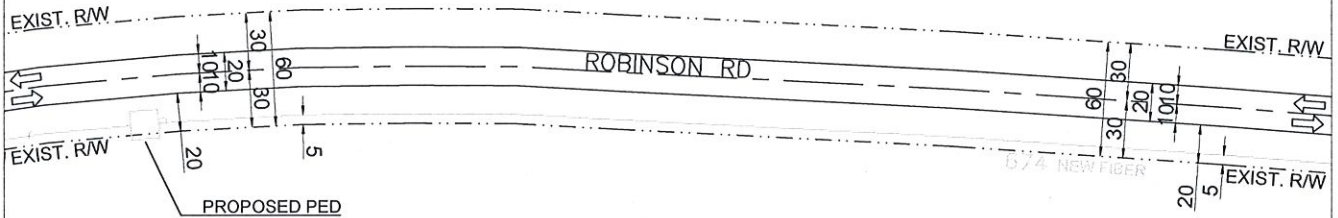

NO MATCH SHEET

PREPARED BY: 	EXISTING POLE PROPOSED PEDESTAL PROPOSED VAULT WATER VALVE FIBER MARKER GAS MARKER MANHOLE SEWER MANHOLE STORM DRAIN	RIGHT OF WAY LINE IRRIGATION LINE WATER LANE GAS LANE PROPOSED ANCHOR PROPOSED RISER LEGEND: RW - RIGHT OF WAY EOP - EDGE OF PAVEMENT DW - DRIVEWAY PDW - PAVED DRIVEWAY	PROPOSED COAXIAL CABLE PROPOSED FIBER CABLE PROPOSED DIRECTIONAL BORE EXISTING CABLE COUNTY LINE		ENGINEERED FOR: 	MADISON COUNTY ROBINSON RD TRANSPORT FIBER
	NOTES: BORE HOLE TO BE FILLED SAME DAY VAULT HOLE TO BE FILLED SAME DAY ALL HOLE TO BE TAMPED AND SODDED			NO SCALE SHEET 7 OF 26		

NO MATCH SHEET

MATCH SHEET 7

NO MATCH SHEET

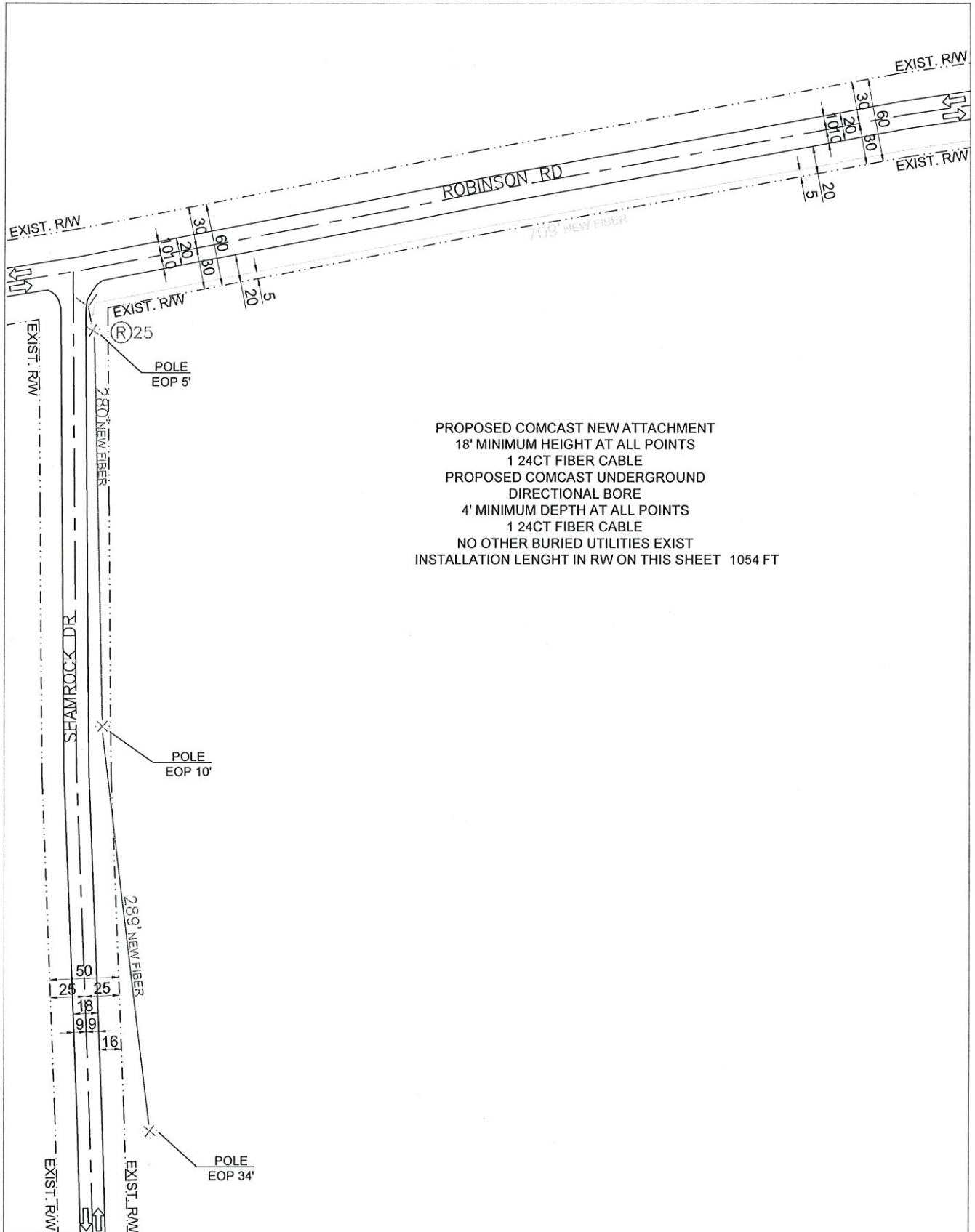

PROPOSED COMCAST NEW ATTACHMENT
 18' MINIMUM HEIGHT AT ALL POINTS
 1 24CT FIBER CABLE
 PROPOSED COMCAST UNDERGROUND
 DIRECTIONAL BORE
 4' MINIMUM DEPTH AT ALL POINTS
 1 24CT FIBER CABLE
 NO OTHER BURIED UTILITIES EXIST
 INSTALLATION LENGTH IN RW ON THIS SHEET 1054 FT

NO MATCH SHEET

PREPARED BY: 	EXISTING POLE PROPOSED PEDESTAL PROPOSED VAULT WATER VALVE FIBER MARKER GAS MARKER MANHOLE SEWER MANHOLE STORM DRAIN	RIGHT OF WAY LINE IRRIGATION LINE WATER LANE GAS LANE PROPOSED ANCHOR PROPOSED RISER LEGEND: RW - RIGHT OF WAY EOP - EDGE OF PAVEMENT DW - DRIVEWAY PDW - PAVED DRIVEWAY	PROPOSED COAXIAL CABLE PROPOSED FIBER CABLE PROPOSED DIRECTIONAL BORE EXISTING CABLE COUNTY LINE		ENGINEERED FOR: 	MADISON COUNTY ROBINSON RD, SHAMROCK DR TRANSPORT FIBER
	NOTES: BORE HOLE TO BE FILLED SAME DAY VAULT HOLE TO BE FILLED SAME DAY ALL HOLE TO BE TAMPED AND SOODED		NO SCALE	SHEET 8 OF 28		

MATCH SHEET 3

PROPOSED COMCAST NEW ATTACHMENT
 18' MINIMUM HEIGHT AT ALL POINTS
 1 48CT FIBER CABLE
 INSTALLATION LENGTH IN RW ON THIS SHEET 900 FT

NO MATCH SHEET

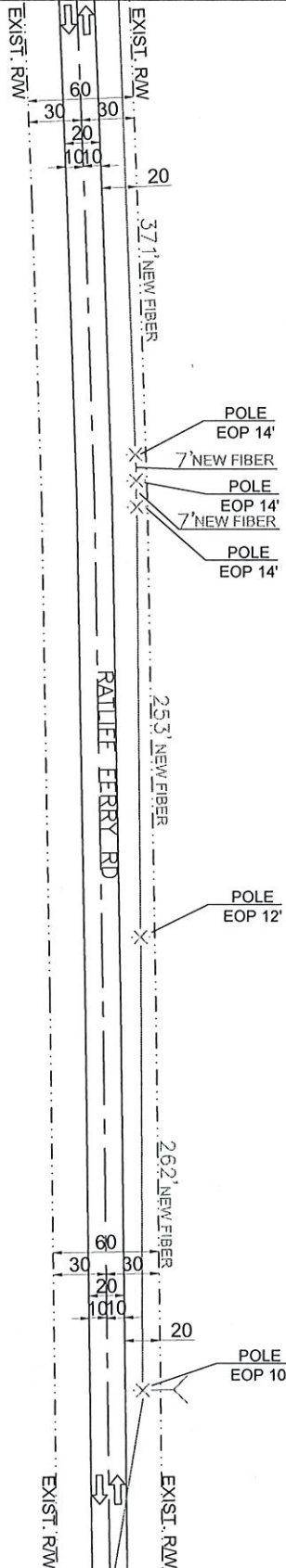

NO MATCH SHEET

MATCH SHEET 10

PREPARED BY: 	EXISTING POLE PROPOSED PEDESTAL PROPOSED VAULT WATER VALVE FIBER MARKER GAS MARKER MANHOLE SEWER MANHOLE STORM DRAIN	RIGHT OF WAY LINE IRRIGATION LINE WATER LANE GAS LANE PROPOSED ANCHOR PROPOSED RISER	PROPOSED COAXIAL CABLE PROPOSED FIBER CABLE PROPOSED DIRECTIONAL BORE EXISTING CABLE COUNTY LINE		ENGINEERED FOR: 	MADISON COUNTY RATLIFF FERRY RD TRANSPORT FIBER
	LEGEND: RW - RIGHT OF WAY EOP - EDGE OF PAVEMENT DW - DRIVEWAY PDW - PAVED DRIVEWAY	NOTES: BORE HOLE TO BE FILLED SAME DAY VAULT HOLE TO BE FILLED SAME DAY ALL HOLE TO BE TAMPED AND SOCCDED	NO SCALE SHEET 9 OF 28			

MATCH SHEET 9

PROPOSED COMCAST NEW ATTACHMENT
 18' MINIMUM HEIGHT AT ALL POINTS
 1 48CT FIBER CABLE
 1 24CT FIBER CABLE
 PROPOSED COMCAST UNDERGROUND
 DIRECTIONAL BORE
 4' MINIMUM DEPTH AT ALL POINTS
 1 24CT FIBER CABLE
 NO OTHER BURIED UTILITIES EXIST
 INSTALLATION LENGTH IN RW ON THIS SHEET 1124 FT

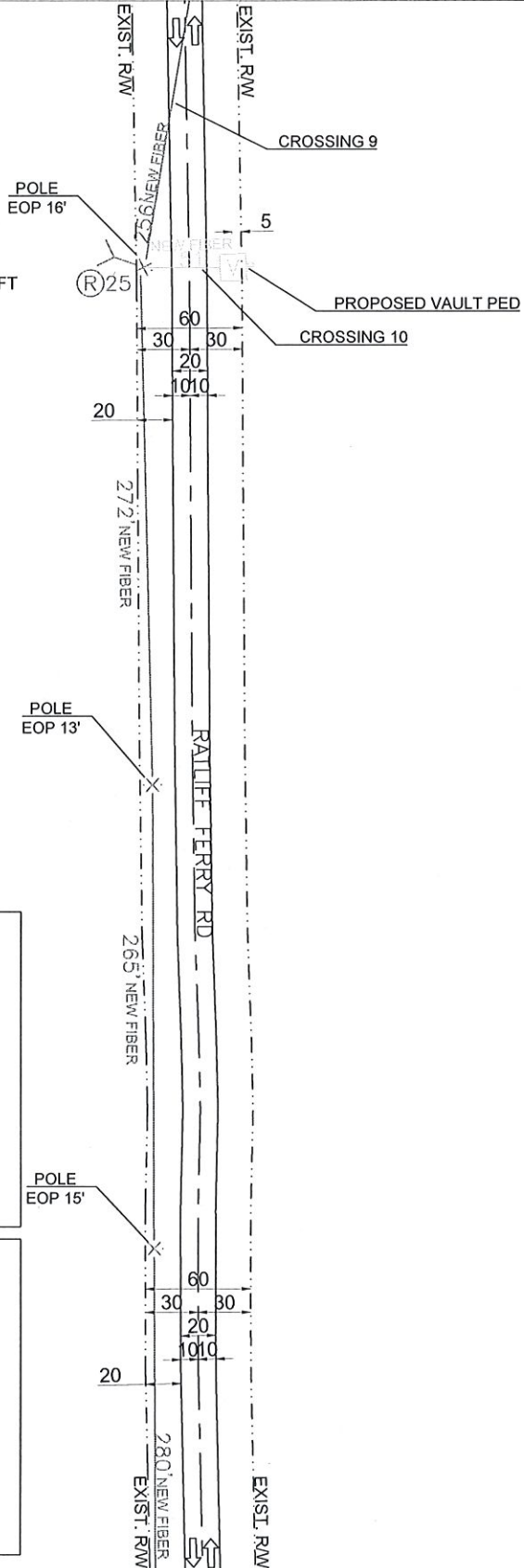

NO MATCH SHEET

NO MATCH SHEET

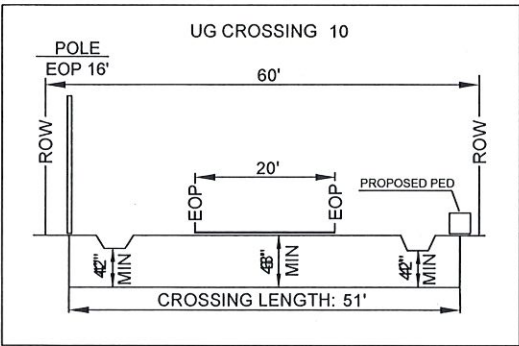
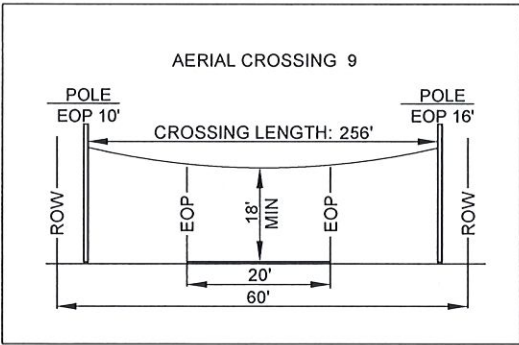

MATCH SHEET 11

PREPARED BY: 	EXISTING POLE PROPOSED PEDESTAL PROPOSED VAULT WATER VALVE FIBER MARKER GAS MARKER MANHOLE SEWER MANHOLE STORM DRAIN	RIGHT OF WAY LINE IRRIGATION LINE WATER LANE GAS LANE PROPOSED ANCHOR PROPOSED RISER	PROPOSED COAXIAL CABLE PROPOSED FIBER CABLE PROPOSED DIRECTIONAL BORE EXISTING CABLE COUNTY LINE		ENGINEERED FOR: MADISON COUNTY RATLIFF FERRY RD TRANSPORT FIBER
	LEGEND: RW - RIGHT OF WAY EOP - EDGE OF PAVEMENT DW - DRIVEWAY PDW - PAVED DRIVEWAY	NOTES: BORE HOLE TO BE FILLED SAME DAY VAULT HOLE TO BE FILLED SAME DAY ALL HOLE TO BE TAMPED AND SODDED			NO SCALE SHEET 10 OF 26

MATCH SHEET 10

PROPOSED COMCAST NEW ATTACHMENT
 18' MINIMUM HEIGHT AT ALL POINTS
 1 48CT FIBER CABLE
 1 24CT FIBER CABLE
 INSTALLATION LENGTH IN RW ON THIS SHEET 503 FT

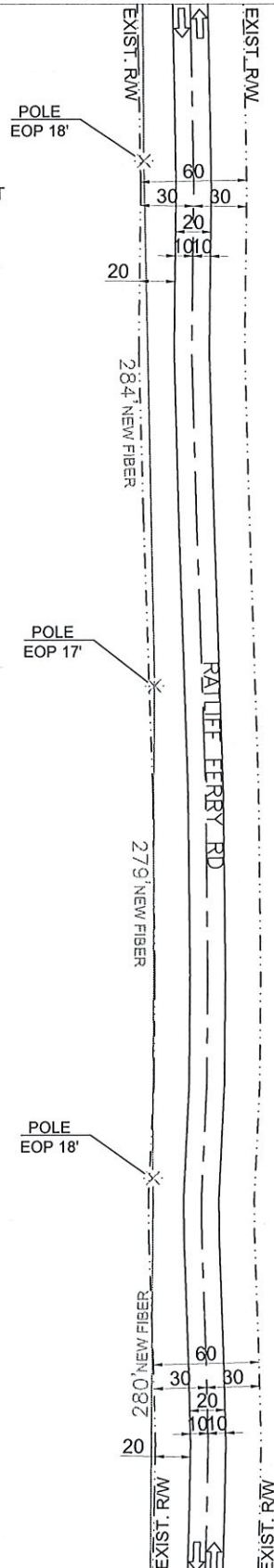

NO MATCH SHEET

NO MATCH SHEET

MATCH SHEET 12

PREPARED BY: 	EXISTING POLE PROPOSED PEDESTAL PROPOSED VAULT WATER VALVE FIBER MARKER GAS MARKER MAINHOLE SEWER MAINHOLE STORM DRAIN	RIGHT OF WAY LINE IRRIGATION LINE WATER LANE GAS LANE PROPOSED ANCHOR PROPOSED RISER	PROPOSED COAXIAL CABLE PROPOSED FIBER CABLE PROPOSED DIRECTIONAL BORE EXISTING CABLE COUNTY LINE		ENGINEERED FOR: 	MADISON COUNTY RATLIFF FERRY RD TRANSPORT FIBER
	LEGEND: RW - RIGHT OF WAY EOP - EDGE OF PAVEMENT DW - DRIVEWAY PDW - PAVED DRIVEWAY	NOTES: BORE HOLE TO BE FILLED SAME DAY VAULT HOLE TO BE FILLED SAME DAY ALL HOLE TO BE TAMPED AND SODDED	NO SCALE SHEET 11 OF 26			

MATCH SHEET 11

NO MATCH SHEET

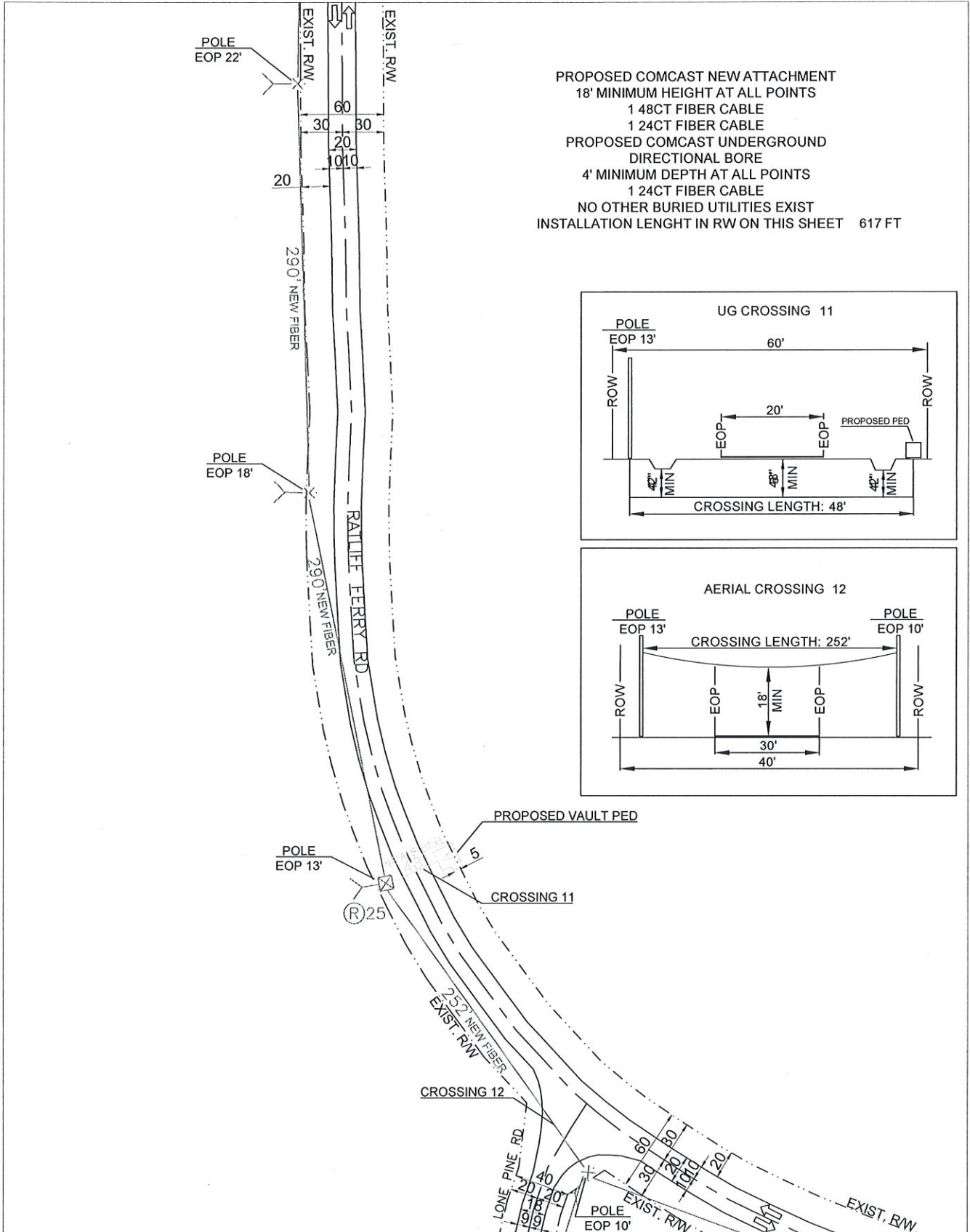

PROPOSED COMCAST NEW ATTACHMENT
 18' MINIMUM HEIGHT AT ALL POINTS
 1 48CT FIBER CABLE
 1 24CT FIBER CABLE
 PROPOSED COMCAST UNDERGROUND
 DIRECTIONAL BORE
 4' MINIMUM DEPTH AT ALL POINTS
 1 24CT FIBER CABLE
 NO OTHER BURIED UTILITIES EXIST
 INSTALLATION LENGTH IN RW ON THIS SHEET 617 FT

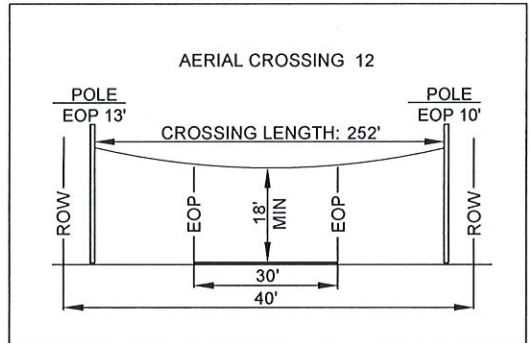
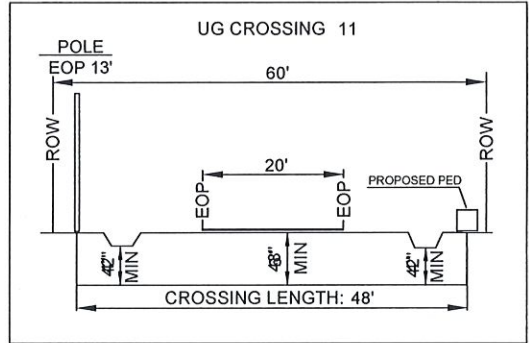

NO MATCH SHEET

MATCH SHEET 13

PREPARED BY: 	EXISTING POLE PROPOSED PEDESTAL PROPOSED VAULT WATER VALVE FIBER MARKER GAS MARKER MANHOLE SEWER MANHOLE STORM DRAIN	RIGHT OF WAY LINE IRRIGATION LINE WATER LANE GAS LANE PROPOSED ANCHOR PROPOSED RISER	PROPOSED COAXIAL CABLE PROPOSED FIBER CABLE PROPOSED DIRECTIONAL BORE EXISTING CABLE COUNTY LINE		ENGINEERED FOR: MADISON COUNTY RATLIFF FERRY RD, LONE PINE RD TRANSPORT FIBER
	LEGEND: RW - RIGHT OF WAY EOP - EDGE OF PAVEMENT DW - DRIVEWAY PDW - PAVED DRIVEWAY	NOTES: BORE HOLE TO BE FILLED SAME DAY VAULT HOLE TO BE FILLED SAME DAY ALL HOLE TO BE TAMPED AND SOODED			NO SCALE SHEET 12 OF 28

PROPOSED COMCAST NEW ATTACHMENT
 18' MINIMUM HEIGHT AT ALL POINTS
 1 48CT FIBER CABLE
 1 24CT FIBER CABLE
 INSTALLATION LENGTH IN RW ON THIS SHEET 572 FT

NO MATCH SHEET

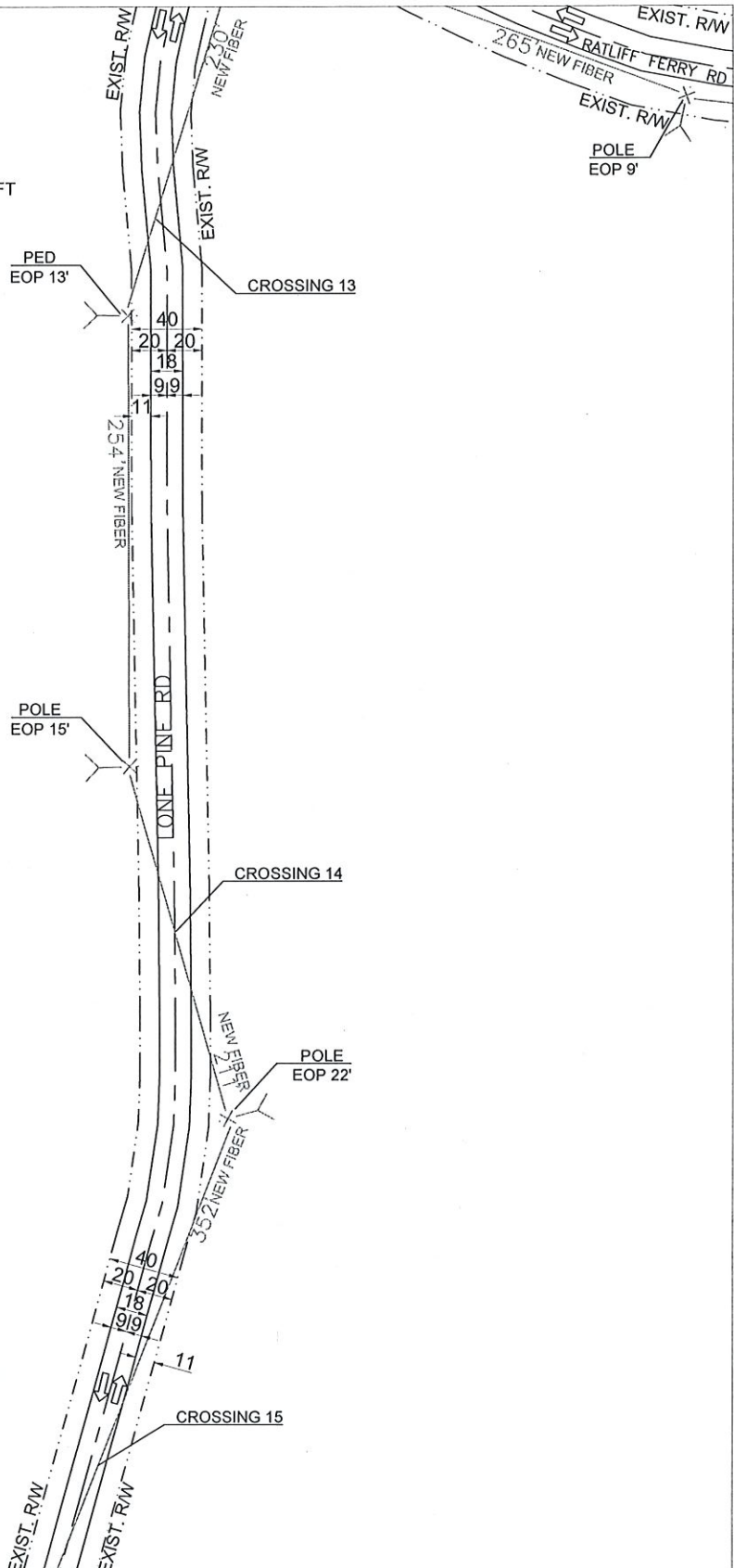
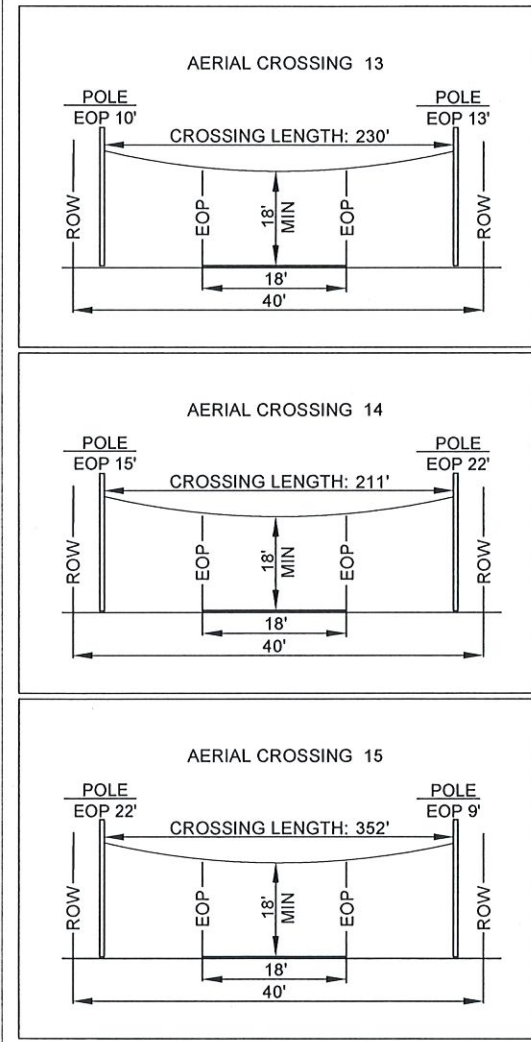

PREPARED BY: 	EXISTING POLE PROPOSED PEDESTAL PROPOSED VAULT WATER VALVE FIBER MARKER GAS MARKER MANHOLE SEWER MANHOLE STORM DRAIN	RIGHT OF WAY LINE IRRIGATION LINE WATER LANE GAS LAINE PROPOSED ANCHOR PROPOSED RISER	PROPOSED COAXIAL CABLE PROPOSED FIBER CABLE PROPOSED DIRECTIONAL BORE EXISTING CABLE COUNTY LINE		ENGINEERED FOR: MADISON COUNTY LONE PINE RD, RATLIFF FERRY RD TRANSPORT FIBER
	LEGEND: RW - RIGHT OF WAY EOP - EDGE OF PAVEMENT DW - DRIVEWAY PDW - PAVED DRIVEWAY	NOTES: BORE HOLE TO BE FILLED SAME DAY VALVE HOLE TO BE FILLED SAME DAY ALL HOLE TO BE TAMPED AND SODDED			NO SCALE SHEET 13 OF 26

MATCH SHEET 13

PROPOSED COMCAST NEW ATTACHMENT
 18' MINIMUM HEIGHT AT ALL POINTS
 1 24CT FIBER CABLE
 INSTALLATION LENGTH IN RW ON THIS SHEET 805 FT

NO MATCH SHEET

NO MATCH SHEET

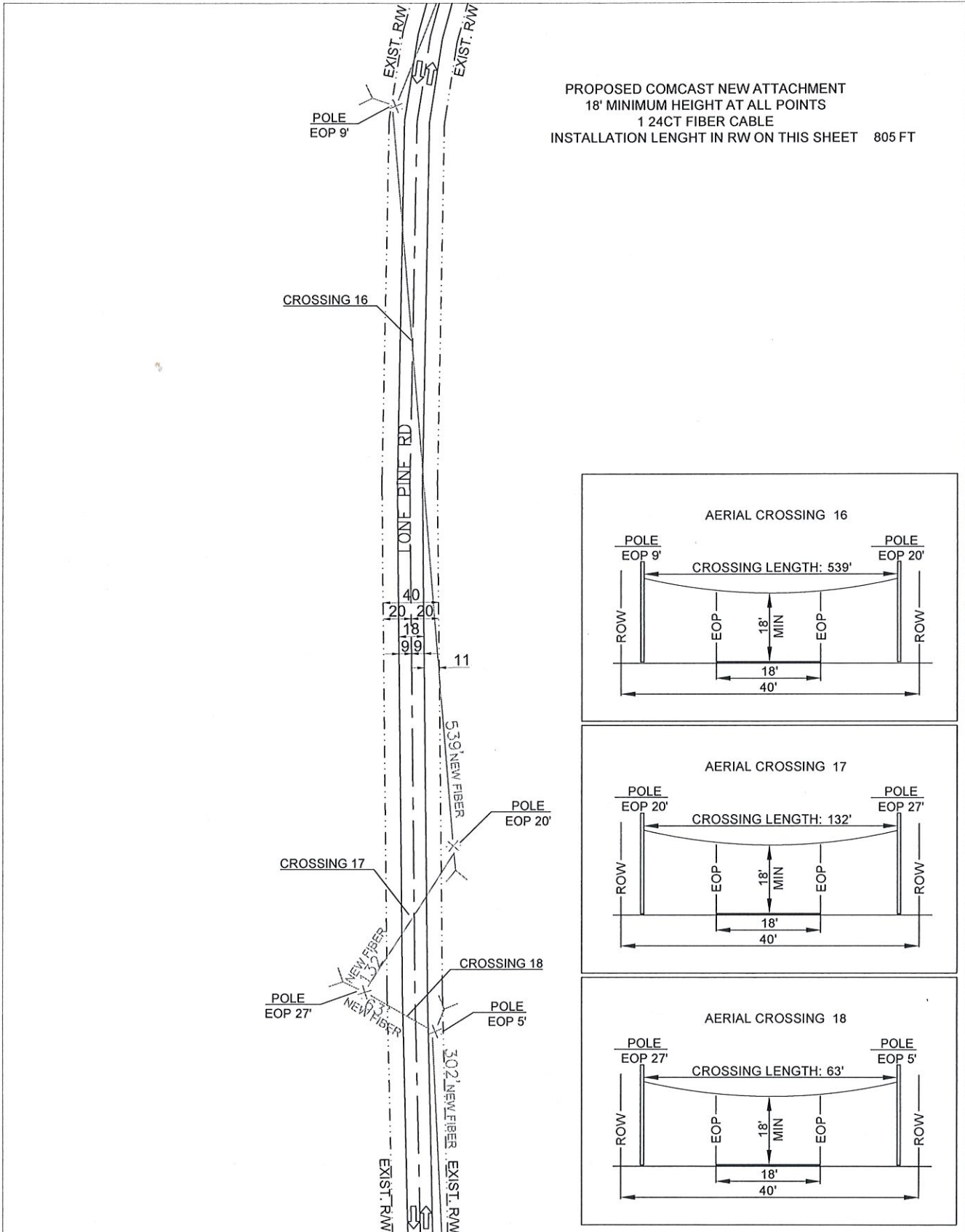

MATCH SHEET 15

PREPARED BY: 	EXISTING POLE PROPOSED PEDESTAL PROPOSED VAULT WATER VALVE FIBER MARKER GAS MARKER MANHOLE SEWER MANHOLE STORM DRAIN	RIGHT OF WAY LINE IRRIGATION LINE WATER LANE GAS LANE PROPOSED ANCHOR PROPOSED RISER	PROPOSED COAXIAL CABLE PROPOSED FIBER CABLE PROPOSED DIRECTIONAL BORE EXISTING CABLE COUNTY LINE		ENGINEERED FOR: 	MADISON COUNTY LONE PINE RD TRANSPORT FIBER
	LEGEND: RW - RIGHT OF WAY EOP - EDGE OF PAVEMENT DW - DRIVEWAY PDW - PAVED DRIVEWAY	NOTES: BORE HOLE TO BE FILLED SAME DAY VAULT HOLE TO BE FILLED SAME DAY ALL HOLE TO BE TAMPED AND SOCCED	NO SCALE SHEET 14 OF 26			

MATCH SHEET 14

PROPOSED COMCAST NEW ATTACHMENT
 18' MINIMUM HEIGHT AT ALL POINTS
 1 24CT FIBER CABLE
 INSTALLATION LENGTH IN RW ON THIS SHEET 656 FT

NO MATCH SHEET

NO MATCH SHEET

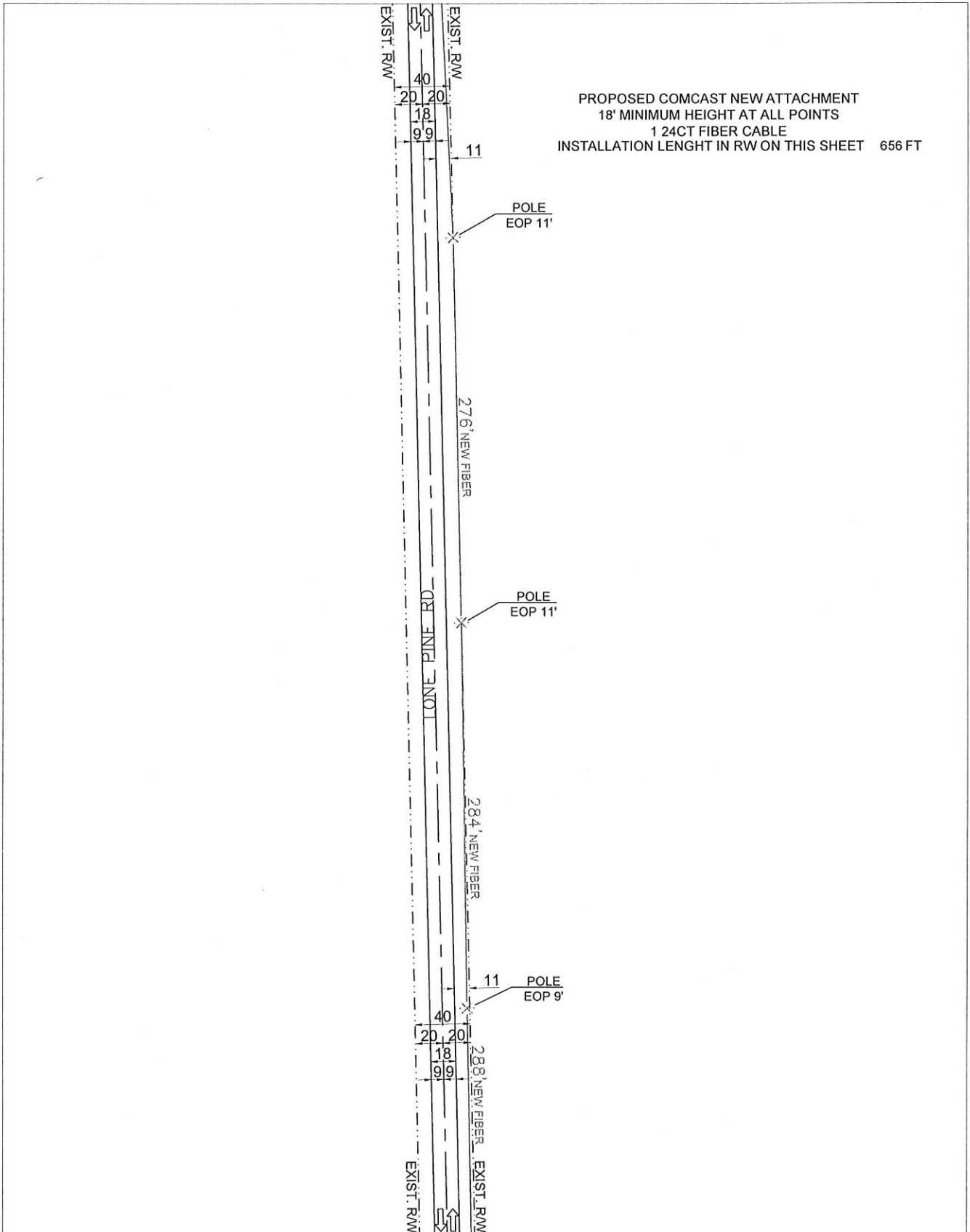

MATCH SHEET 16

PREPARED BY: 	EXISTING POLE PROPOSED PEDESTAL PROPOSED VAULT WATER VALVE FIBER MARKER GAS MARKER MANHOLE SEWER MANHOLE STORM DRAIN	RIGHT OF WAY LINE IRRIGATION LINE WATER LANE GAS LANE PROPOSED ANCHOR PROPOSED RISER (R) 25	PROPOSED COAXIAL CABLE PROPOSED FIBER CABLE PROPOSED DIRECTIONAL BORE EXISTING CABLE COUNTY LINE		ENGINEERED FOR: 	MADISON COUNTY LONE PINE RD TRANSPORT FIBER
	LEGEND: RW - RIGHT OF WAY EOP - EDGE OF PAVEMENT DW - DRIVEWAY PDW - PAVED DRIVEWAY				NOTES: BORE HOLE TO BE FILLED SAME DAY VAULT HOLE TO BE FILLED SAME DAY ALL HOLE TO BE TAMPED AND SODDED	NO SCALE SHEET 15 OF 26

MATCH SHEET 15

PROPOSED COMCAST NEW ATTACHMENT
 18' MINIMUM HEIGHT AT ALL POINTS
 1 24CT FIBER CABLE
 INSTALLATION LENGHT IN RW ON THIS SHEET 840 FT

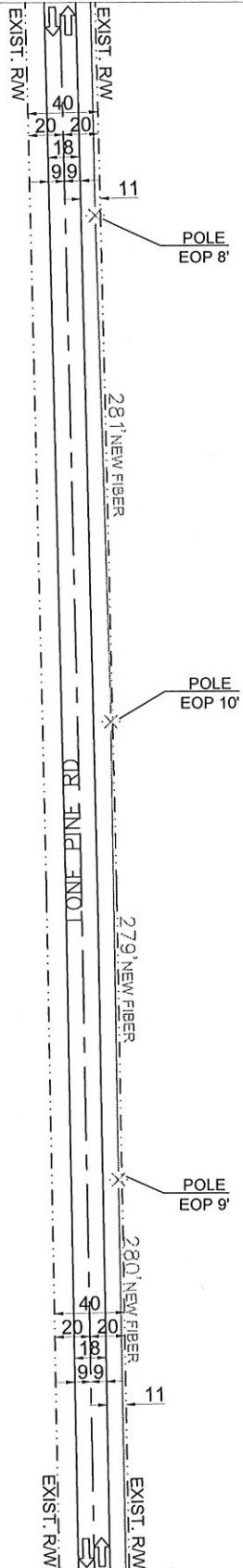

NO MATCH SHEET

NO MATCH SHEET

MATCH SHEET 17

PREPARED BY: 	EXISTING POLE PROPOSED PEDESTAL PROPOSED VAULT WATER VALVE FIBER MARKER GAS MARKER MANHOLE SEWER MAINHOLE STORM DRAIN	RIGHT OF WAY LINE IRRIGATION LINE WATER LANE GAS LAJE PROPOSED ANCHOR PROPOSED RISER	PROPOSED COAXIAL CABLE PROPOSED FIBER CABLE PROPOSED DIRECTIONAL BORE EXISTING CABLE COUNTY LINE		ENGINEERED FOR: 	MADISON COUNTY LONE PINE RD TRANSPORT FIBER
	LEGEND: RW - RIGHT OF WAY EOP - EDGE OF PAVEMENT DV - DRIVEWAY PDW - PAVED DRIVEWAY	NOTES: BORE HOLE TO BE FILLED SAME DAY VAULT HOLE TO BE FILLED SAME DAY ALL HOLE TO BE TAMPED AND SODDED	NO SCALE SHEET 16 OF 26			

MATCH SHEET 16

PROPOSED COMCAST NEW ATTACHMENT
 18' MINIMUM HEIGHT AT ALL POINTS
 1 24CT FIBER CABLE
 INSTALLATION LENGTH IN RW ON THIS SHEET 345 FT

NO MATCH SHEET

NO MATCH SHEET

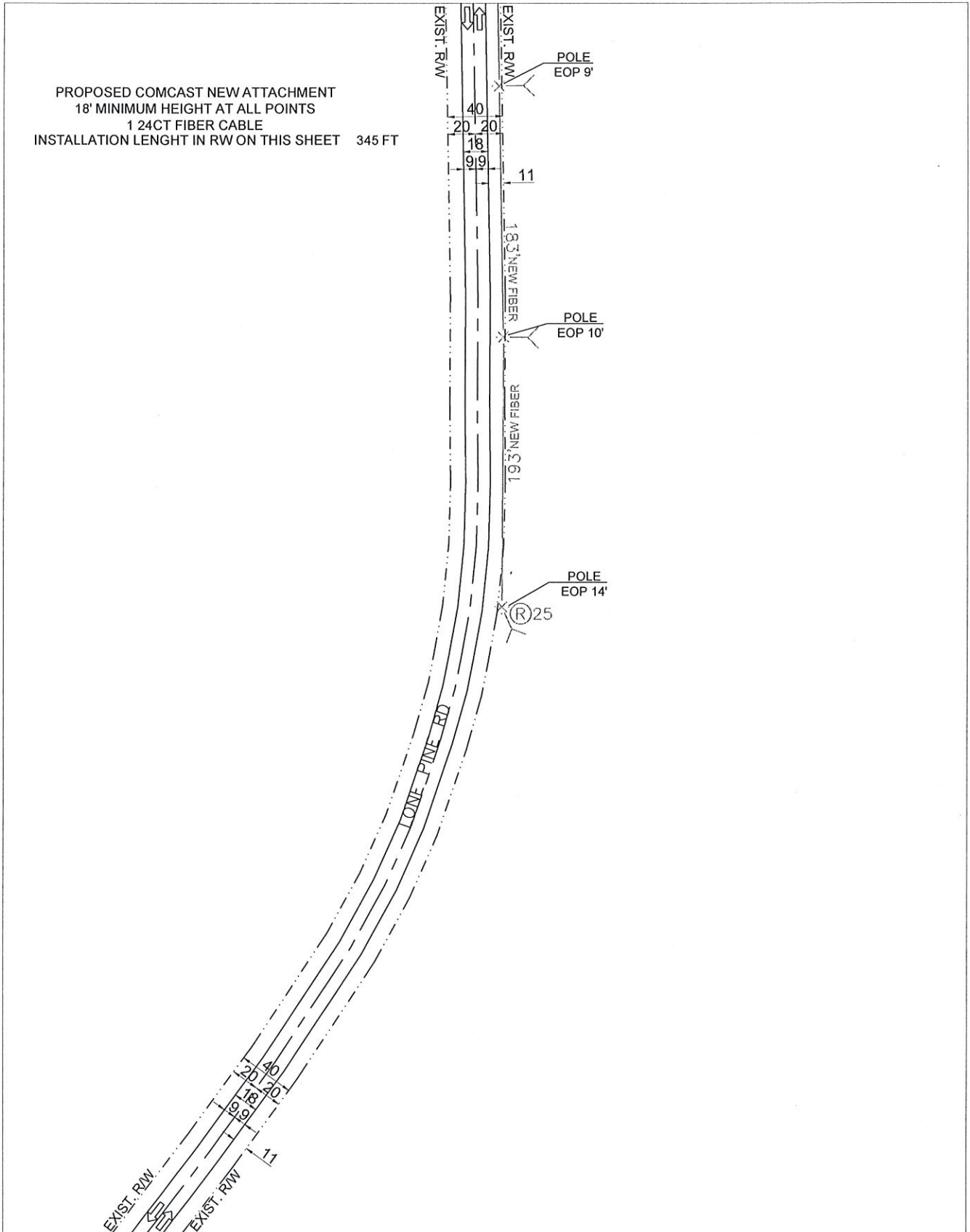

NO MATCH SHEET

PREPARED BY: 	EXISTING POLE PROPOSED PEDESTAL PROPOSED VAULT WATER VALVE FIBER MARKER GAS MARKER MANHOLE SEWER MANHOLE STORM DRAIN	RIGHT OF WAY LINE IRRIGATION LINE WATER LANE GAS LANE PROPOSED ANCHOR PROPOSED RISER	PROPOSED COAXIAL CABLE PROPOSED FIBER CABLE PROPOSED DIRECTIONAL BORE EXISTING CABLE COUNTY LINE		ENGINEERED FOR: 	MADISON COUNTY LONE PINE RD TRANSPORT FIBER
	LEGEND: RW - RIGHT OF WAY EOP - EDGE OF PAVEMENT DW - DRIVEWAY PDW - PAVED DRIVEWAY	NOTES: BORE HOLE TO BE FILLED SAME DAY VAULT HOLE TO BE FILLED SAME DAY ALL HOLE TO BE TAMPED AND SOODED	NO SCALE SHEET 17 OF 28			

NO MATCH SHEET

PROPOSED COMCAST NEW ATTACHMENT
 18' MINIMUM HEIGHT AT ALL POINTS
 1 48CT FIBER CABLE
 1 24CT FIBER CABLE
 PROPOSED COMCAST UNDERGROUND
 DIRECTIONAL BORE
 4' MINIMUM DEPTH AT ALL POINTS
 1 24CT FIBER CABLE
 NO OTHER BURIED UTILITIES EXIST
 INSTALLATION LENGTH IN RW ON THIS SHEET 821 FT

MATCH SHEET 13

MATCH SHEET 19

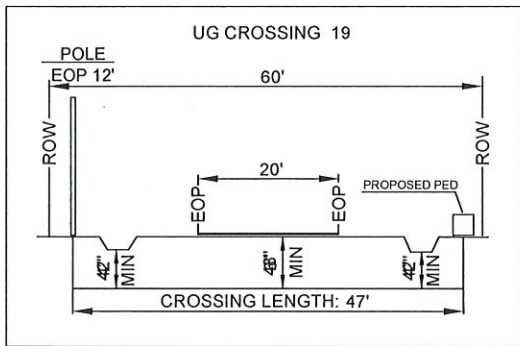
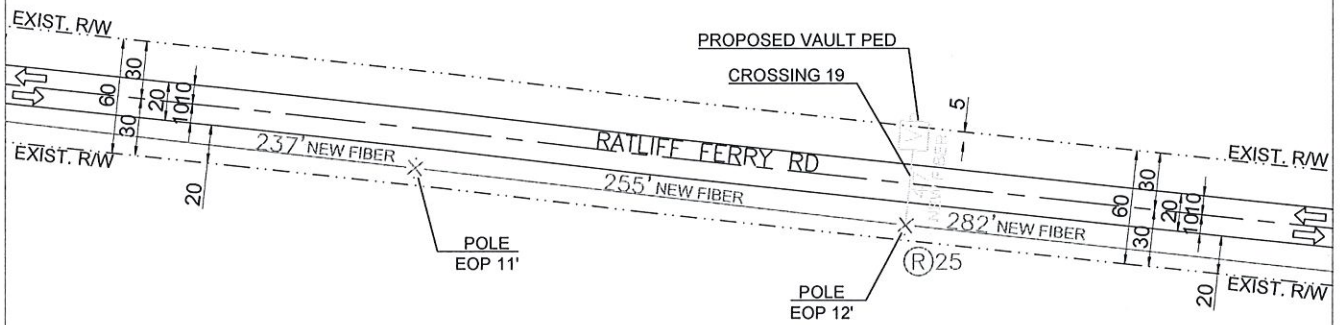

NO MATCH SHEET

PREPARED BY: 	EXISTING POLE PROPOSED PEDESTAL PROPOSED VAULT WATER VALVE FIBER MARKER GAS MARKER MANHOLE SEWER MAINHOLE STORM DRAIN	RIGHT OF WAY LINE IRRIGATION LINE WATER LANE GAS LANE PROPOSED ANCHOR PROPOSED RISER	PROPOSED COAXIAL CABLE PROPOSED FIBER CABLE PROPOSED DIRECTIONAL BORE EXISTING CABLE COUNTY LINE		ENGINEERED FOR: 	MADISON COUNTY RATLIFF FERRY RD TRANSPORT FIBER
	LEGEND: RW - RIGHT OF WAY EOP - EDGE OF PAVEMENT DW - DRIVEWAY PDW - PAVED DRIVEWAY	NOTES: BORE HOLE TO BE FILLED SAME DAY VAULT HOLE TO BE FILLED SAME DAY ALL HOLE TO BE TAMPED AND SODDED	NO SCALE SHEET 18 OF 28			

NO MATCH SHEET

PROPOSED COMCAST NEW ATTACHMENT
 18' MINIMUM HEIGHT AT ALL POINTS
 1 48CT FIBER CABLE
 1 24CT FIBER CABLE
 INSTALLATION LENGTH IN RW ON THIS SHEET 533 FT

MATCH SHEET 18

MATCH SHEET 20

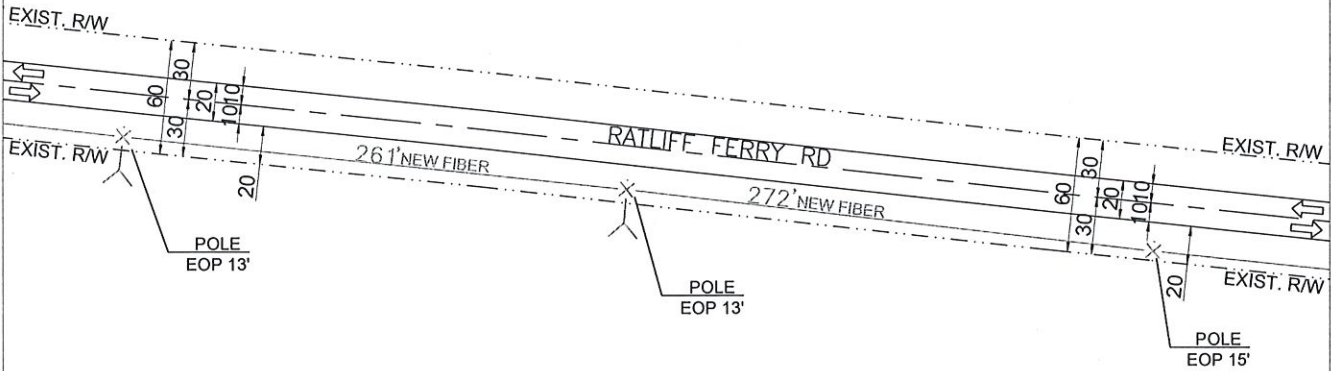

NO MATCH SHEET

PREPARED BY: 	EXISTING POLE PROPOSED PEDESTAL PROPOSED VAULT WATER VALVE FIBER MARKER GAS MARKER MANHOLE SEWER MANHOLE STORM DRAIN	RIGHT OF WAY LINE IRRIGATION LINE WATER LANE GAS LANE PROPOSED ANCHOR PROPOSED RISER	PROPOSED COAXIAL CABLE PROPOSED FIBER CABLE PROPOSED DIRECTIONAL BORE EXISTING CABLE COUNTY LINE		ENGINEERED FOR: 	MADISON COUNTY RATLIFF FERRY RD TRANSPORT FIBER
	LEGEND: RW - RIGHT OF WAY EOP - EDGE OF PAVEMENT DW - DRIVEWAY PDW - PAVED DRIVEWAY	NOTES: BORE HOLE TO BE FILLED SAME DAY VAULT HOLE TO BE FILLED SAME DAY ALL HOLE TO BE TAMPED AND SODDED	NO SCALE SHEET 19 OF 26			

NO MATCH SHEET

PROPOSED COMCAST NEW ATTACHMENT
 18' MINIMUM HEIGHT AT ALL POINTS
 1 48CT FIBER CABLE
 INSTALLATION LENGTH IN RW ON THIS SHEET 821 FT

MATCH SHEET 19

MATCH SHEET 21

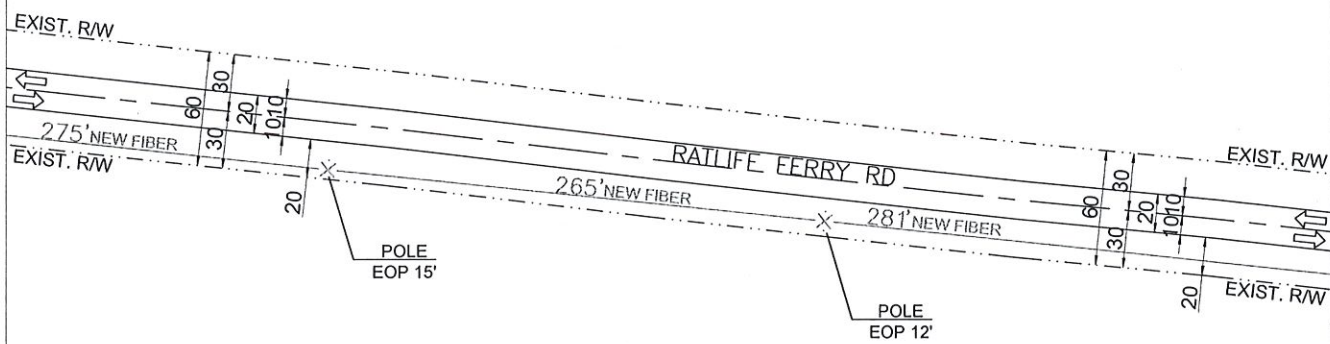

NO MATCH SHEET

PREPARED BY: 	EXISTING POLE PROPOSED PEDESTAL PROPOSED VAULT WATER VALVE FIBER MARKER GAS MARKER MANHOLE SEWER MANHOLE STORM DRAIN	RIGHT OF WAY LINE IRRIGATION LINE WATER LANE GAS LANE PROPOSED ANCHOR PROPOSED RISER	PROPOSED COAXIAL CABLE PROPOSED FIBER CABLE PROPOSED DIRECTIONAL BORE EXISTING CABLE COUNTY LINE		ENGINEERED FOR: 	MADISON COUNTY RATLIFF FERRY RD TRANSPORT FIBER
	LEGEND: RW - RIGHT OF WAY EOP - EDGE OF PAVEMENT DW - DRIVEWAY PDW - PAVED DRIVEWAY	NOTES: BORE HOLE TO BE FILLED SAME DAY VAULT HOLE TO BE FILLED SAME DAY ALL HOLE TO BE TAMPED AND SODDED	NO SCALE		SHEET 20 OF 26	

NO MATCH SHEET

PROPOSED COMCAST NEW ATTACHMENT
 18' MINIMUM HEIGHT AT ALL POINTS
 1 48CT FIBER CABLE
 1 24CT FIBER CABLE
 INSTALLATION LENGTH IN RW ON THIS SHEET 823 FT

MATCH SHEET 20

MATCH SHEET 22

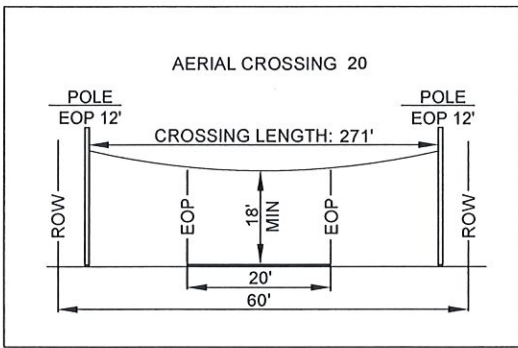
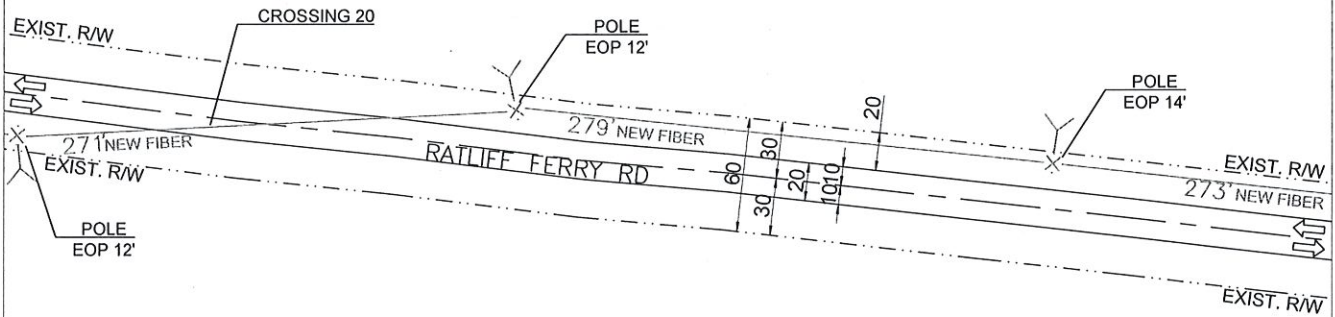

NO MATCH SHEET

PREPARED BY: 	EXISTING POLE PROPOSED PEDESTAL PROPOSED VAULT WATER VALVE FIBER MARKER GAS MARKER MANHOLE SEWER MANHOLE STORM DRAIN	RIGHT OF WAY LINE IRRIGATION LINE WATER LANE GAS LANE PROPOSED ANCHOR PROPOSED RISER	PROPOSED COAXIAL CABLE PROPOSED FIBER CABLE PROPOSED DIRECTIONAL BORE EXISTING CABLE COUNTY LINE		ENGINEERED FOR: 	MADISON COUNTY RATLIFF FERRY RD TRANSPORT FIBER
	LEGEND: RW - RIGHT OF WAY EOP - EDGE OF PAVEMENT DW - DRIVEWAY PDW - PAVED DRIVEWAY	NOTES: BORE HOLE TO BE FILLED SAME DAY VAULT HOLE TO BE FILLED SAME DAY ALL HOLE TO BE TAMPED AND SOCCDED	NO SCALE SHEET 21 OF 28			

NO MATCH SHEET

PROPOSED COMCAST NEW ATTACHMENT
 18' MINIMUM HEIGHT AT ALL POINTS
 1 48CT FIBER CABLE
 INSTALLATION LENGHT IN RW ON THIS SHEET 540 FT

MATCH SHEET 21

MATCH SHEET 23

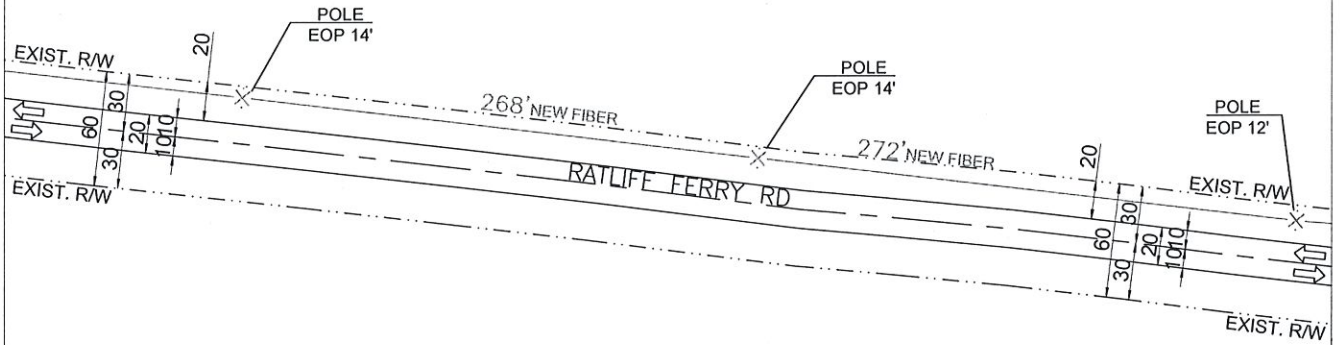

NO MATCH SHEET

PREPARED BY: 	EXISTING POLE PROPOSED PEDESTAL PROPOSED VAULT WATER VALVE FIBER MARKER GAS MARKER MANHOLE SEWER MAINHOLE STORM DRAIN	RIGHT OF WAY LINE IRRIGATION LINE WATER LANE GAS LANE PROPOSED ANCHOR PROPOSED RISER	PROPOSED COAXIAL CABLE PROPOSED FIBER CABLE PROPOSED DIRECTIONAL BORE EXISTING CABLE COUNTY LINE		ENGINEERED FOR: 	MADISON COUNTY RATLIFF FERRY RD TRANSPORT FIBER
	LEGEND: RW - RIGHT OF WAY EOP - EDGE OF PAVEMENT DW - DRIVEWAY PDW - PAVED DRIVEWAY	NOTES: BORE HOLE TO BE FILLED SAME DAY VAULT HOLE TO BE FILLED SAME DAY ALL HOLE TO BE TAMPED AND SODDED	NO SCALE SHEET 22 OF 28			

NO MATCH SHEET

PROPOSED COMCAST NEW ATTACHMENT
 18' MINIMUM HEIGHT AT ALL POINTS
 1 48CT FIBER CABLE
 1 24CT FIBER CABLE
 INSTALLATION LENGHT IN RW ON THIS SHEET 270 FT

MATCH SHEET 22

MATCH SHEET 24

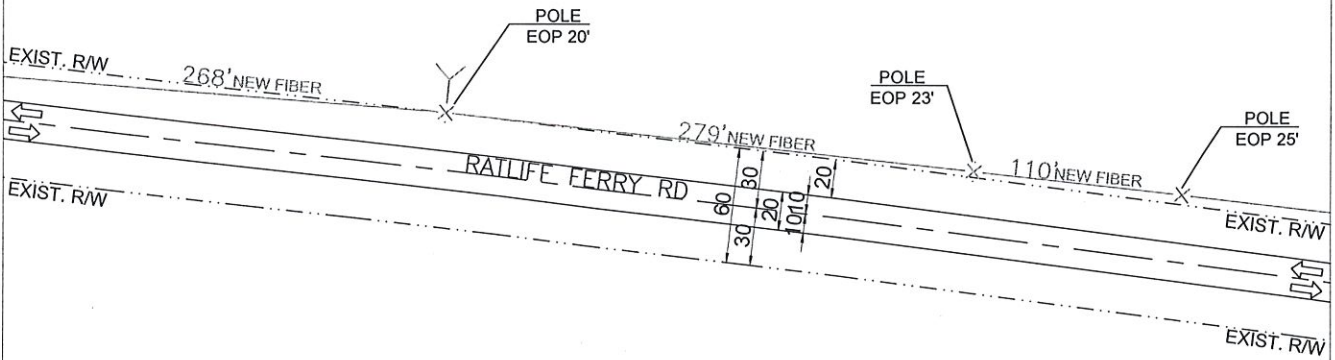

NO MATCH SHEET

PREPARED BY: 	EXISTING POLE PROPOSED PEDESTAL PROPOSED VAULT WATER VALVE FIBER MARKER GAS MARKER MANHOLE SEWER MANHOLE STORM DRAIN	RIGHT OF WAY LINE IRRIGATION LINE WATER LANE GAS LANE PROPOSED ANCHOR PROPOSED RISER	PROPOSED COAXIAL CABLE PROPOSED FIBER CABLE PROPOSED DIRECTIONAL BORE EXISTING CABLE COUNTY LINE		ENGINEERED FOR: 	MADISON COUNTY RATLIFF FERRY RD TRANSPORT FIBER
	LEGEND: RW - RIGHT OF WAY EOP - EDGE OF PAVEMENT DW - DRIVEWAY PDW - PAVED DRIVEWAY	NOTES: BORE HOLE TO BE FILLED SAME DAY VAULT HOLE TO BE FILLED SAME DAY ALL HOLE TO BE TAMPED AND SOODED	NO SCALE		SHEET 23 OF 26	

NO MATCH SHEET

PROPOSED COMCAST NEW ATTACHMENT
 18' MINIMUM HEIGHT AT ALL POINTS
 1 48CT FIBER CABLE
 1 24CT FIBER CABLE
 INSTALLATION LENGHT IN RW ON THIS SHEET 0 FT

MATCH SHEET 23

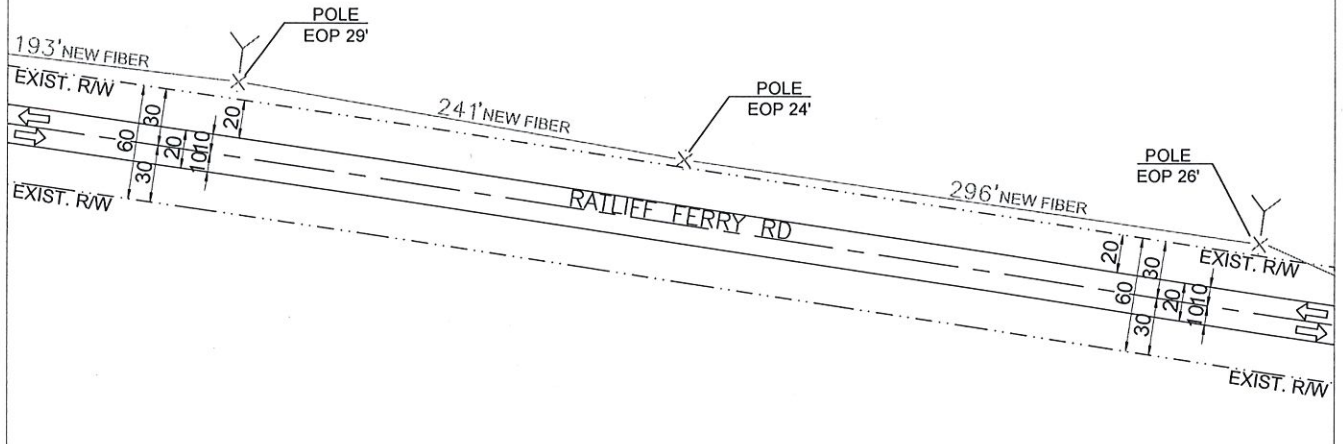

MATCH SHEET 25

NO MATCH SHEET

PREPARED BY: 	EXISTING POLE PROPOSED PEDESTAL PROPOSED VAULT WATER VALVE FIBER MARKER GAS MARKER MANHOLE SEWER MANHOLE STORM DRAIN	RIGHT OF WAY LINE IRRIGATION LINE WATER LANE GAS LANE PROPOSED ANCHOR PROPOSED RISER	PROPOSED COAXIAL CABLE PROPOSED FIBER CABLE PROPOSED DIRECTIONAL BORE EXISTING CABLE COUNTY LINE		ENGINEERED FOR: 	MADISON COUNTY RATLIFF FERRY RD TRANSPORT FIBER
	LEGEND: RW - RIGHT OF WAY EOP - EDGE OF PAVEMENT DW - DRIVEWAY PDW - PAVED DRIVEWAY	NOTES: BORE HOLE TO BE FILLED SAME DAY VAULT HOLE TO BE FILLED SAME DAY ALL HOLE TO BE TAMPED AND SODDED	NO SCALE		SHEET 24 OF 28	

NO MATCH SHEET

PROPOSED COMCAST NEW ATTACHMENT
 18' MINIMUM HEIGHT AT ALL POINTS
 1 48CT FIBER CABLE
 1 24CT FIBER CABLE
 INSTALLATION LENGTH IN RW ON THIS SHEET 743 FT

MATCH SHEET 24

MATCH SHEET 26

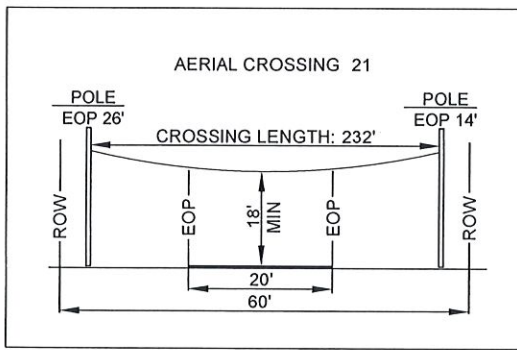
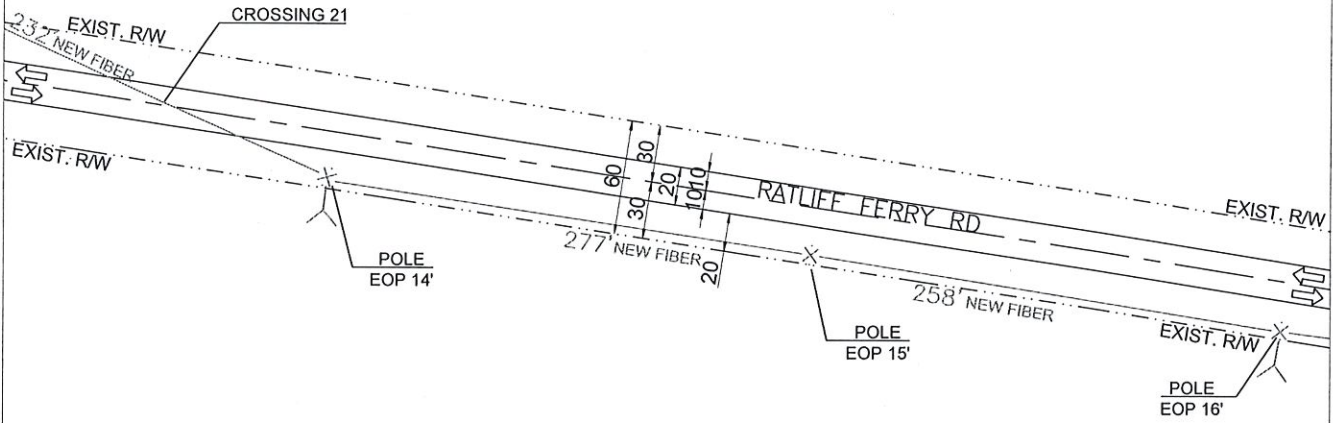

NO MATCH SHEET

PREPARED BY: 	EXISTING POLE PROPOSED PEDESTAL PROPOSED VAULT WATER VALVE FIBER MARKER GAS MARKER MANHOLE SEWER MANHOLE STORM DRAIN	RIGHT OF WAY LINE IRRIGATION LINE WATER LANE GAS LANE PROPOSED ANCHOR PROPOSED RISER	PROPOSED COAXIAL CABLE PROPOSED FIBER CABLE PROPOSED DIRECTIONAL BORE EXISTING CABLE COUNTY LINE		ENGINEERED FOR: MADISON COUNTY RATLIFF FERRY RD TRANSPORT FIBER
	LEGEND: RW - RIGHT OF WAY EOP - EDGE OF PAVEMENT DW - DRIVEWAY POW - PAVED DRIVEWAY	NOTES: BORE HOLE TO BE FILLED SAME DAY VAULT HOLE TO BE FILLED SAME DAY ALL HOLE TO BE TAMPED AND SODDED			NO SCALE SHEET 25 OF 26

NO MATCH SHEET

PROPOSED COMCAST NEW ATTACHMENT
 18' MINIMUM HEIGHT AT ALL POINTS
 1 48CT FIBER CABLE
 1 24CT FIBER CABLE
 INSTALLATION LENGTH IN RW ON THIS SHEET 689 FT
 TOTAL INSTALLATION LENGTH 1894 FT
 AERIAL: 16488 FT
 UG: 2457 FT
 START 32.627199, -89.901774
 END 32.60762, -89.880394

MATCH SHEET 25

NO MATCH SHEET

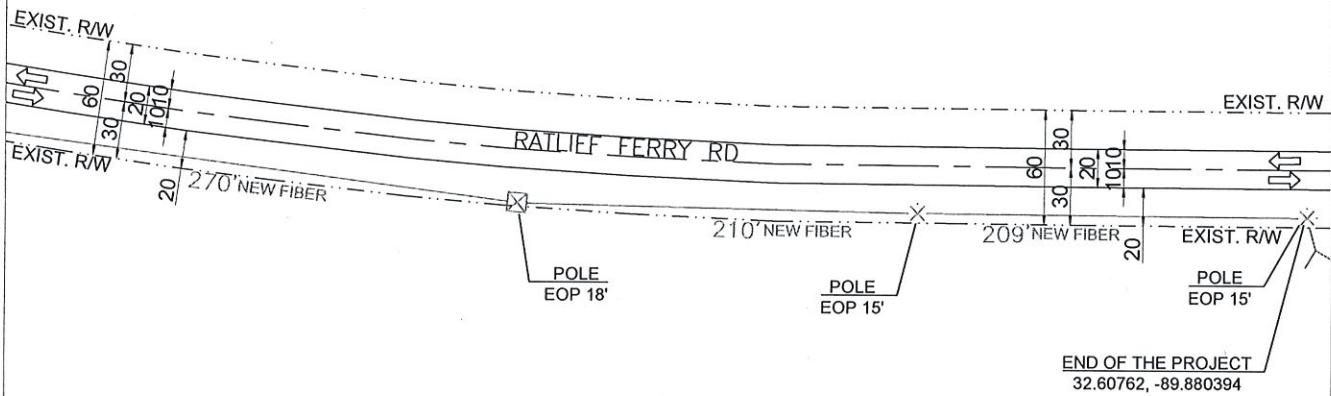

NO MATCH SHEET

PREPARED BY: 	EXISTING POLE PROPOSED PEDESTAL PROPOSED VAULT WATER VALVE FIBER MARKER GAS MARKER MANHOLE SEWER MANHOLE STORM DRAIN	RIGHT OF WAY LINE IRRIGATION LINE WATER LAJE GAS LAJE PROPOSED ANCHOR PROPOSED RISER	PROPOSED COAXIAL CABLE PROPOSED FIBER CABLE PROPOSED DIRECTIONAL BORE EXISTING CABLE COUNTY LINE		ENGINEERED FOR: 	MADISON COUNTY RATLIFF FERRY RD TRANSPORT FIBER
	LEGEND: RW - RIGHT OF WAY EOP - EDGE OF PAVEMENT DW - DRIVEWAY PDW - PAVED DRIVEWAY	NOTES: BORE HOLE TO BE FILLED SAME DAY VAULT HOLE TO BE FILLED SAME DAY ALL HOLE TO BE TAMPED AND SODDED	NO SCALE SHEET 26 OF 26			